

Facilities

Utah State UNIVERSITY

Campus Map

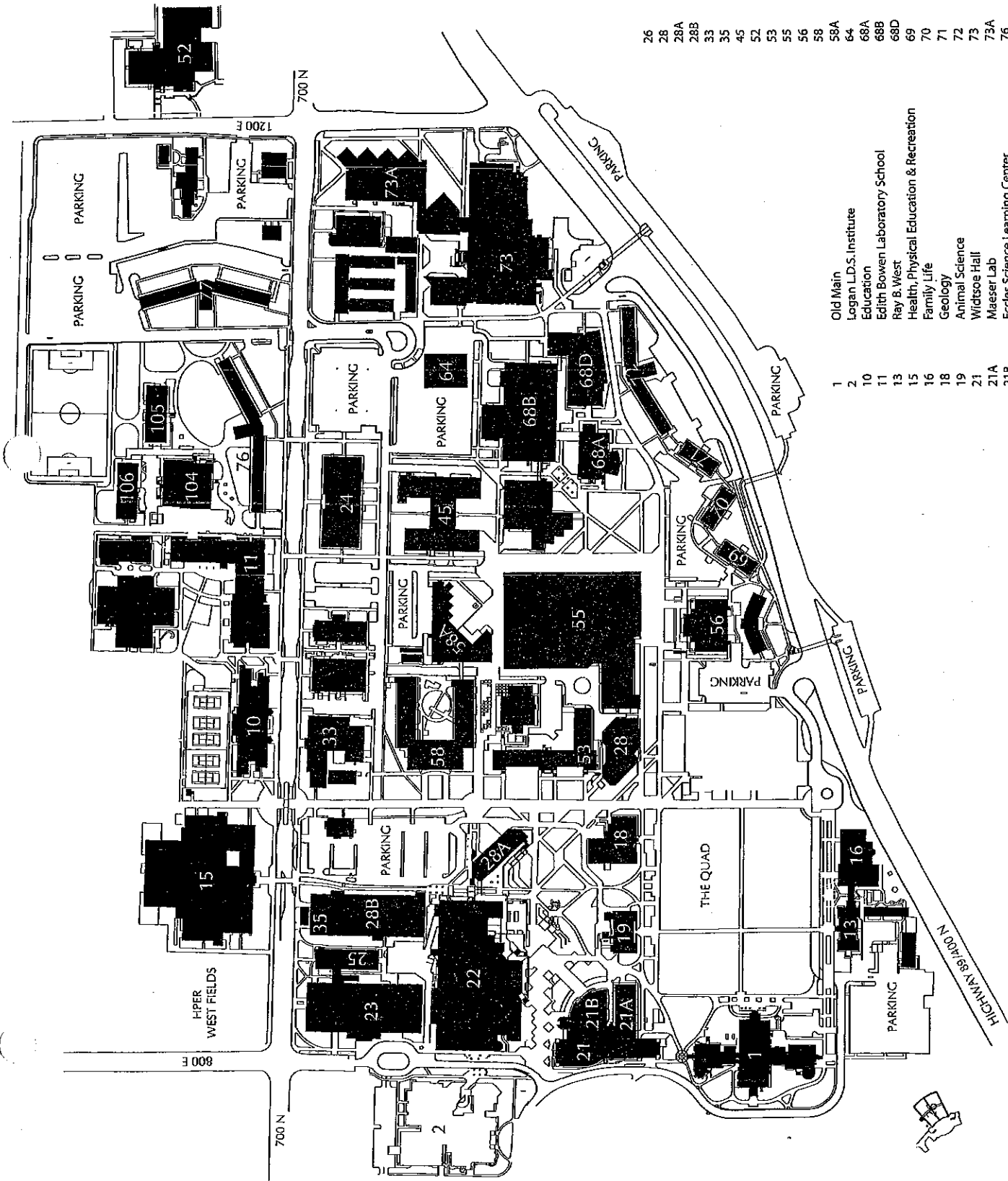
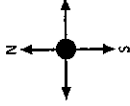

- 26 Amphitheater
- 28 Eccles Conference Center
- 28A University Inn
- 28B Parking Terrace
- 33 Veterinary Science and Bacteriology
- 35 Information Traffic Control
- 45 Technology
- 52 Nutrition & Food Science
- 53 Agricultural Science
- 55 Merrill-Cazier Library
- 56 Business
- 58 Biology-Natural Resources
- 58A Natural Resources
- 64 Performance Hall
- 68A Engineering Classroom
- 68B Engineering Laboratory
- 68D Engineering
- 69 Moeen Hall
- 70 Greaves Hall
- 71 Reeder Hall
- 72 Merrill Hall
- 73 Fine Arts Center
- 73A Fine Arts Visual
- 76 Richards Hall
- 77 Bullen Hall
- 104 Junction
- 105 Mountain View Tower
- 106 Valley View Tower

- 1 Old Main
- 2 Logan L.D.S. Institute
- 10 Education
- 11 Edith Bowen Laboratory School
- 13 Ray B. West
- 15 Health, Physical Education & Recreation
- 16 Family Life
- 18 Geology
- 19 Animal Science
- 21 Widtsoe Hall
- 21A Maeser Lab
- 21B Eccles Science Learning Center
- 22 Taggart Student Center
- 23 Fieldhouse (Nelson Recreation Center)
- 24 Industrial Science
- 25 Military Science

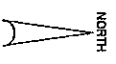
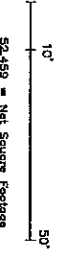
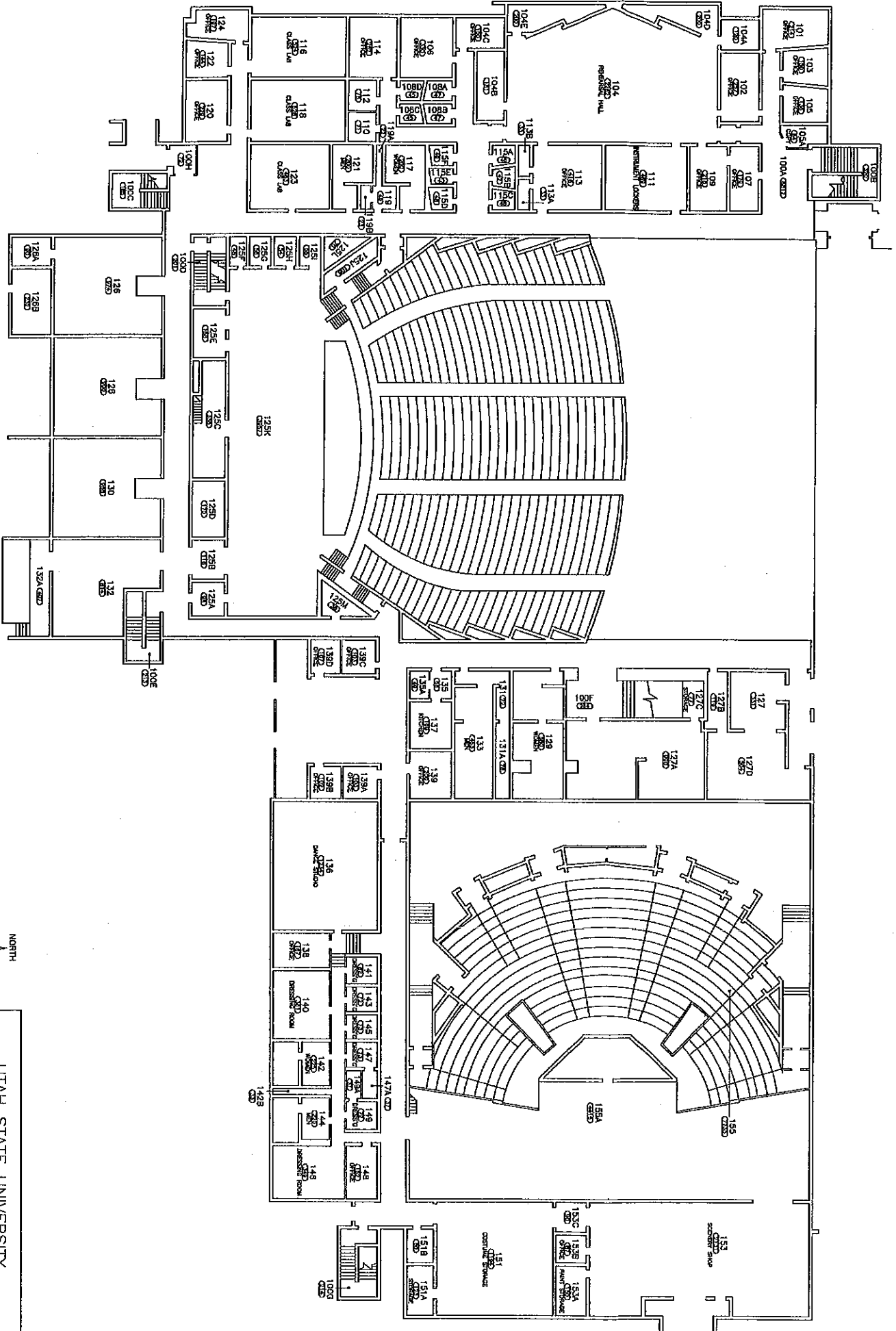

| | |
|-----------------------|----------------|
| UTAH STATE UNIVERSITY | |
| SCALE: 1"=40' | BLDG NO: 73 |
| DATE: 11 MAR 04 | REVISION: 7/04 |
| FINE ARTS | |
| FIRST FLOOR | |
| 2 OF 5 | |

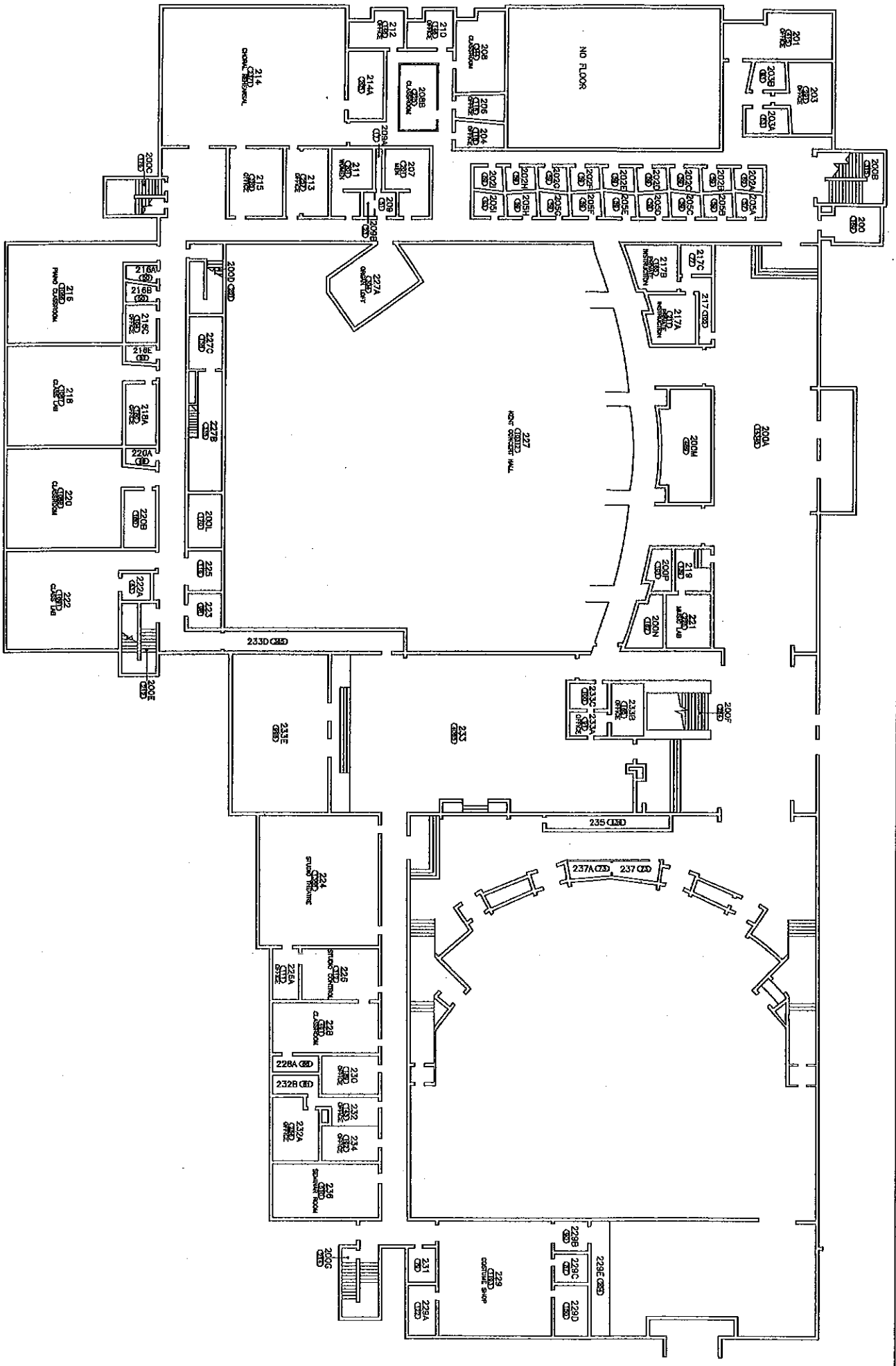

10'
50'
52,534 = Net Square Footage



| | |
|-----------------------|----------------|
| UTAH STATE UNIVERSITY | |
| SCALE: 1"=40' | BLDG NO: 73 |
| DATE: 28 MAY 04 | REVISION: 7/04 |
| FINE ARTS | |
| SECOND FLOOR | 3 OF 5 |

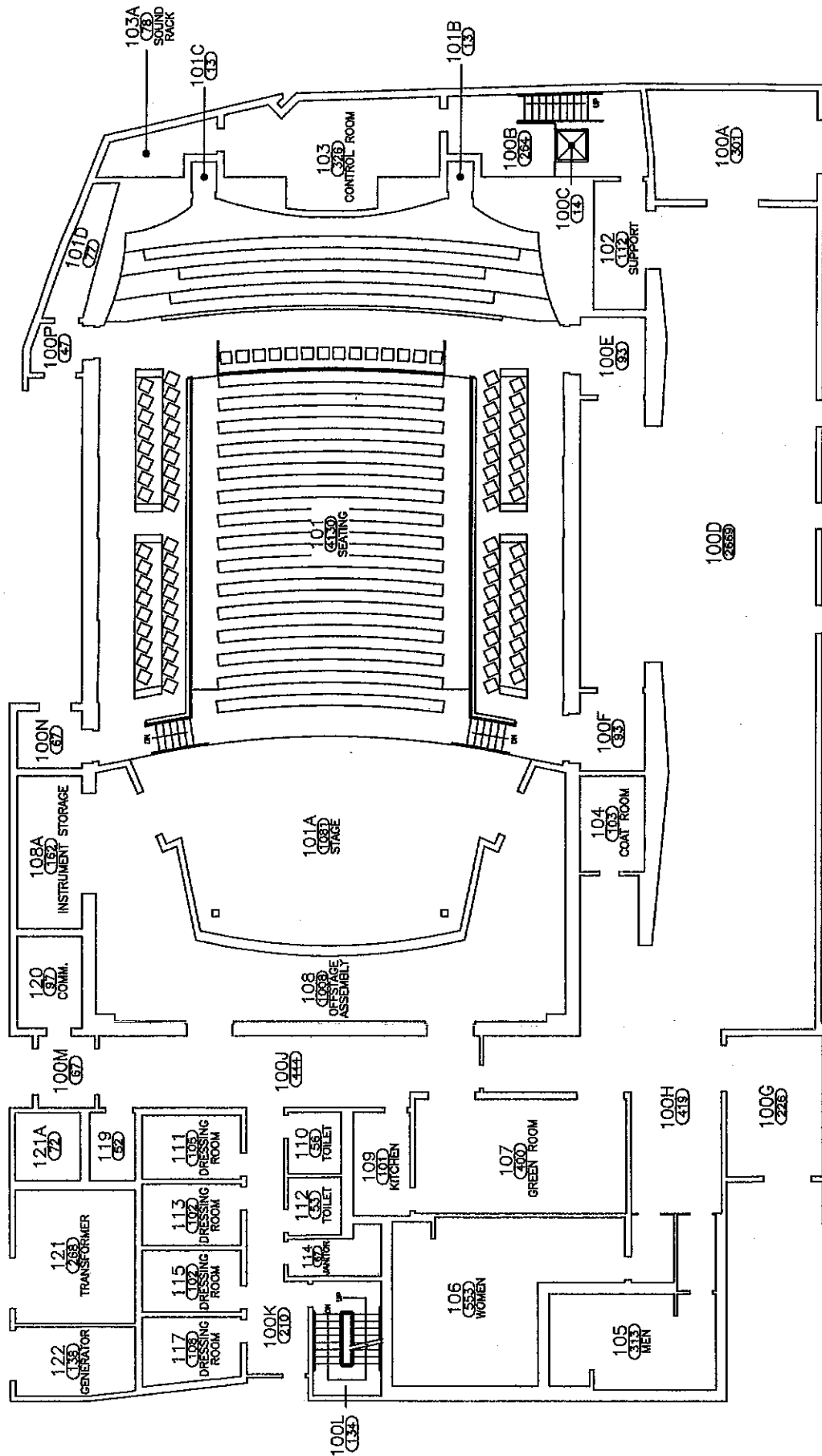

14,738 = Net Square Footage
 16,811 = Gross Square Footage

| | |
|-----------------------|------------------|
| UTAH STATE UNIVERSITY | |
| SCALE: 1"=30' | DRAWN BY: BF |
| DATE: 2 AUG 05 | BLDG NO. 73D |
| | REVISION: |
| FIRST FLOOR | PERFORMANCE HALL |
| | 2 OF 3 |

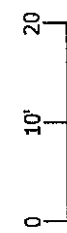
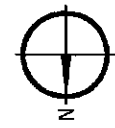
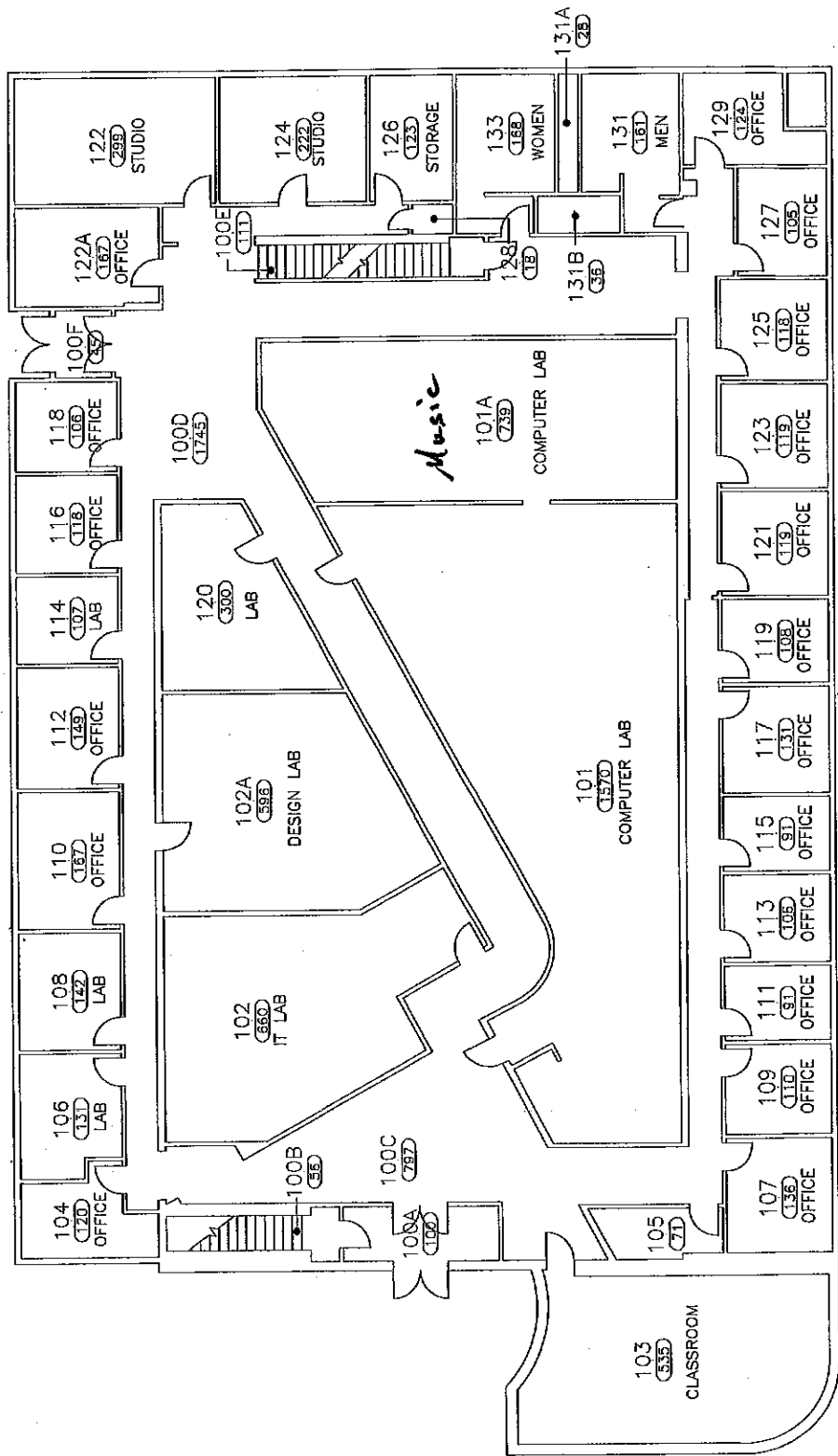

Year Constructed: 1951
 Revised: July 2007
 Net Sq. Ft.: 10,945

61 - University Reserve

First Floor

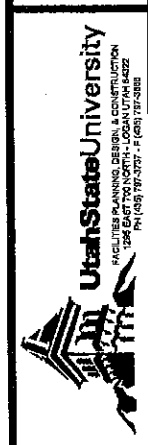

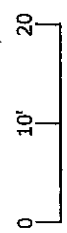
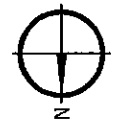
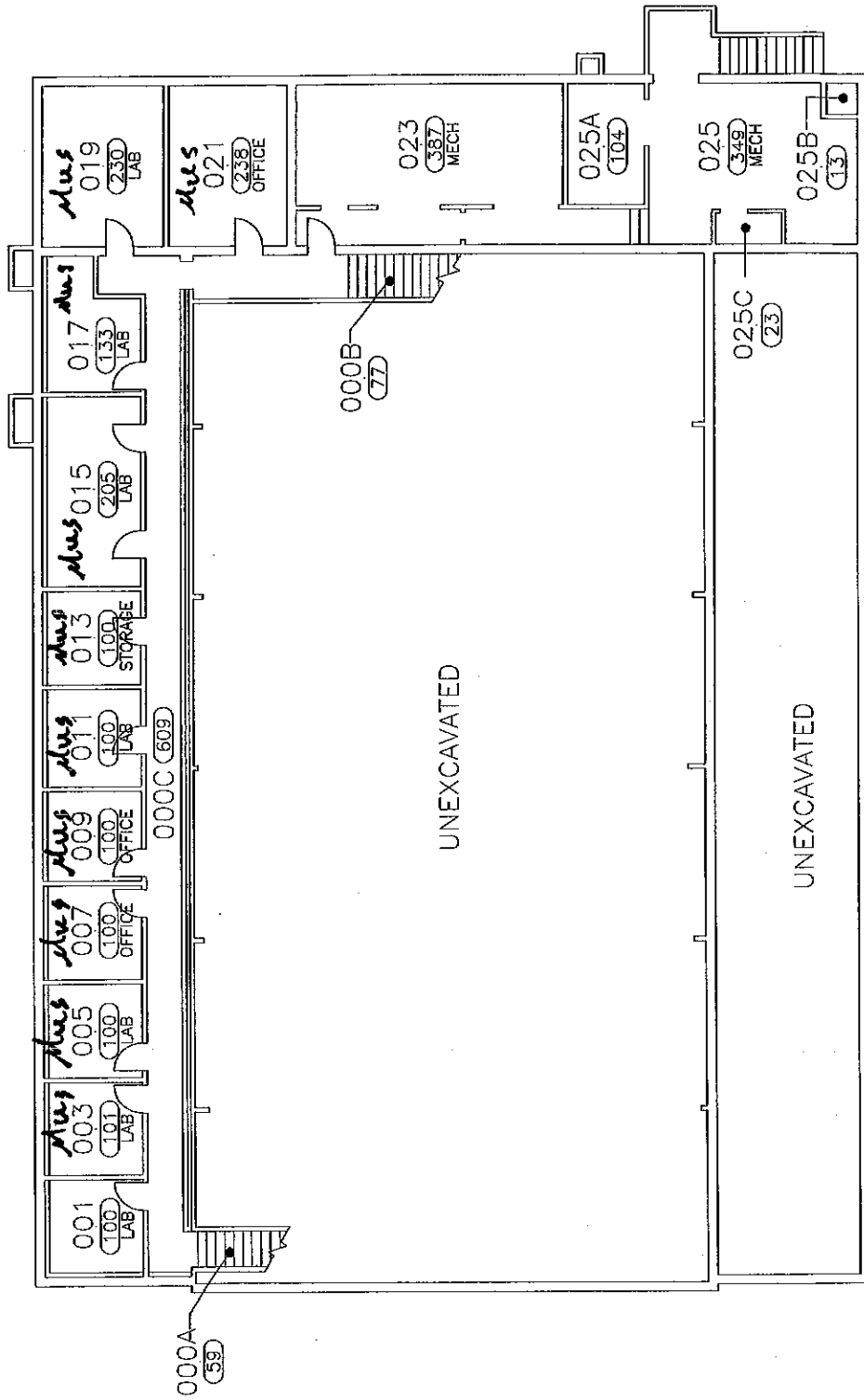

Year Constructed: 1951
 Revised: September 2007
 Net Sq. Ft.: 3,128

61 - University Reserve Basement



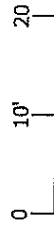
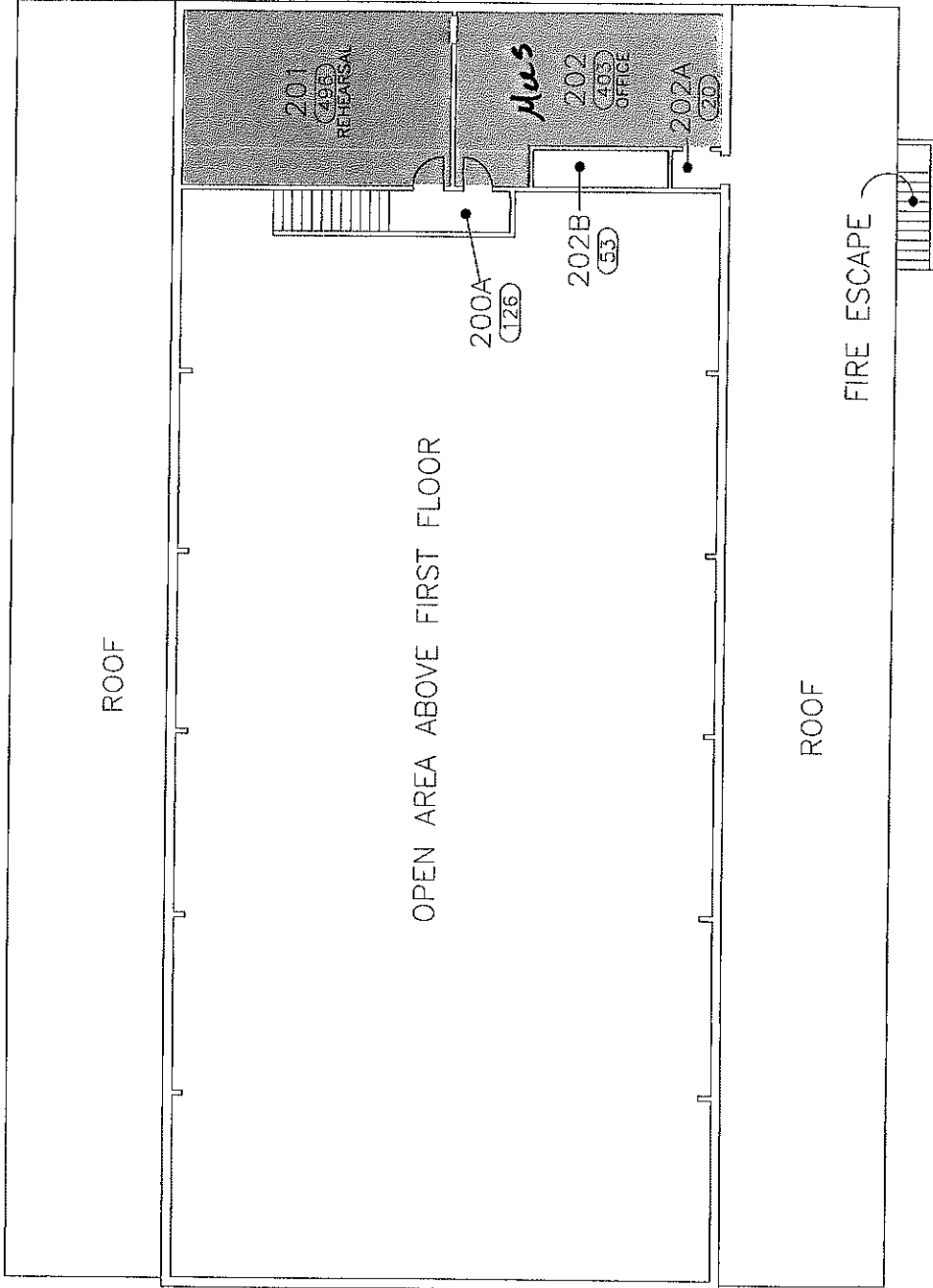

Year Constructed: 1951
 Revised: September 2007
 Net Sq. Ft.: 1,098

61 - University Reserve
 Second Floor



Equipment

MUSI \$5000 AND OVER FINAL INVENTORY LIST 02/04/2013

| INV # | LOC | ACQ DATE | AMOUNT | DESCRIPTION | MAKE | MODEL | SERIAL/IN # | A G NAME | LICENSE | INV DATE | RESPONSIBLE AREA |
|--------|--------|------------------------|-----------|----------------------------|---------------|------------|-------------|------------------------|---------|------------------------|---------------------------|
| 47388 | FA125E | 1992/01/01 00:00:00 | 46,000.00 | GRAND PIANO 9FT | 92 STEINWAY | D | 520127 | Hirst, Russell D. | | 2013/02/04 00:00:00 | |
| 73168 | FA104 | 1997/08/01 00:00:00 | 8,961.00 | MARIMBA | 97 YAMAHA | 6000 | 0211 | Griffin, Dennis | | 2013/02/04 00:00:00 | |
| 75255 | FA104 | 1999/10/01 00:00:00 | 6,000.00 | MARIMBA W/RESONATOR | 98 YAMAHA | YM4900 | 1060 | Nicholson, Jason E. | | 2013/02/04 00:00:00 | |
| 75526 | FA216 | 1998/02/01 00:00:00 | 13,500.00 | ORGAN | 98 RODGERS | 7511 | ZK50296 | Bankhead, James K. | | 2013/02/04 00:00:00 | |
| 81250 | FV129 | 1999/05/01 00:00:00 | 11,931.00 | GRAND PIANO | 99 YAMAHA | C2 | 5614051 | Hirst, Russell D. | | 2013/02/04 00:00:00 | |
| 85045 | FA105 | 1999/12/01 00:00:00 | 5,785.00 | BASS FLUTE | 99 ALTUS | ALTUSBF822 | B476 | Timmons, Leslie J. | | 2013/02/04 00:00:00 | |
| 88641 | FA214 | 2000/08/01 00:00:00 | 12,000.00 | GRAND PIANO | USED STEINWAY | O | 130703 | Hirst, Russell D. | | 2013/02/04 00:00:00 | |
| 88722 | FA202I | 2000/09/01 00:00:00 | 26,000.00 | BABY GRAND PIANO | 00 STEINWAY | BABY GRAND | 551826 | Hirst, Russell D. | | 2013/02/04 00:00:00 | |
| 89857 | FA205I | 2001/04/01 00:00:00 | 30,000.00 | GRAND PIANO | 01 STEINWAY | M-E GRAND | 554653 | Hirst, Russell D. | | 2013/02/04 00:00:00 | |
| 91741 | FA233E | 2001/10/01 00:00:00 | 29,500.00 | GRAND PIANO | 01 STEINWAY | GRAND | 522247/437 | Hirst, Russell D. | | 2013/02/04 00:00:00 | |
| 92262 | FA111 | 2002/02/01 00:00:00 | 7,553.00 | TUBA | 02 GETZEN | G50L | 31083 | Fallis, Todd L. | | 2013/02/04 00:00:00 | CHECKED OUT TO STUDENT |
| 92616 | FA120 | 2002/03/01 00:00:00 | 8,000.00 | SATIN GRAND PIANO | 02 BOSTON | 156ES | 140088 | Fallis, Todd L. | | 2013/02/04 00:00:00 | |
| 95552 | UR202 | 2003/03/01 00:00:00 | 12,000.00 | CELLO | USED | | | Francis, Anne | | 2013/02/04 00:00:00 | |
| 96433 | UR005 | 2003/06/01 00:00:00 | 11,967.00 | GRAND PIANO CONSERVATORY | 03 YAMAHA | 58" GRAND | 5981157 | Hirst, Russell D. | | 2013/02/04 00:00:00 | |
| 97905 | FA217A | 2003/09/01 00:00:00 | 12,500.00 | GRAND PIANO | 03 BOSTON | 156ES | 144306 | Hirst, Russell D. | | 2013/02/04 00:00:00 | |
| 98587 | FA110 | 2003/10/01 00:00:00 | 10,400.00 | MARIMBA | 03 | SW 1 | 3516 | Nicholson, Jason E. | | 2013/02/04 00:00:00 | |
| 98837 | FA125A | 2003/12/01 00:00:00 | 40,800.00 | GRAND PIANO | 03 STEINWAY | D-EBONY | 553750 | Hirst, Russell D. | | 2013/02/04 00:00:00 | |
| 99323 | FA104 | 1997/05/01 00:00:00 | 6,160.00 | GRAND PIANO: WALNUT FINISH | 57 STEINWAY | GRAND | 354217 | Hirst, Russell D. | | 2013/02/04 00:00:00 | |
| 99324 | FA220 | 1976/01/01 00:00:00 | 9,274.00 | PIANO GRAND EBONY | 76 STEINWAY | D | 444384 | Hirst, Russell D. | | 2013/02/04 00:00:00 | |
| 99325 | FA104 | 1955/06/01 00:00:00 | 6,000.00 | PIANO GRAND | 55 STEINWAY | K116 | 347831 | Hirst, Russell D. | | 2013/02/04 00:00:00 | OUT FOR REPAIR |
| 100768 | FA214 | 1966/08/01 00:00:00 | 5,832.00 | GRAND PIANO CONCERT | 66 STEINWAY | D | 395276 | Hirst, Russell D. | | 2013/02/04 00:00:00 | |

MUSI \$5000 AND OVER FINAL INVENTORY LIST 02/04/2013

| INV # | SUB | LOC | ACQ DATE | AMOUNT | DESCRIPTION | MAKE | MODEL | SERIAL/VIN # | A | G NAME | LICENSE | INV DATE | RESPONSIBLE AREA |
|--------|-----|--------|------------------------|------------|----------------------------------|-----------------------|--------------------------------|-----------------------|---|----------------------------|----------|------------------------|---------------------------|
| 106322 | | FA111 | 2007/01/26 00:00:00 | 8,663.98 | BASS CLARINET | 07 BUFFET | BC R13 W/LOW C | H41867 | | Morrison, P Nicholas E. | | 2013/02/04 00:00:00 | CHECKED OUT TO STUDENT |
| 108047 | | FA203A | 2006/12/07 00:00:00 | 11,000.00 | GRAND PIANO | USED STEINWAY | GRAND | 400660 | 1 | Hirst, Russell D. | | 2013/02/04 00:00:00 | |
| 108224 | | FA203 | 1999/10/01 00:00:00 | 69,000.00 | GRAND PIANO | 99 STEINWAY | CONCERT | 546748 | 1 | Hirst, Russell D. | | 2013/02/04 00:00:00 | |
| 108226 | | FA217B | 1998/04/01 00:00:00 | 13,930.00 | GRAND PIANO | 97 BOSTON | 163 | B110856 | 1 | Hirst, Russell D. | | 2013/02/04 00:00:00 | |
| 108616 | | FA200 | 2007/01/12 00:00:00 | 7,425.00 | GRAND PIANO | 07 BOSTON | ES156 | 156407 | 1 | Hirst, Russell D. | | 2013/02/04 00:00:00 | |
| 109469 | | UR001 | 2007/05/25 00:00:00 | 14,795.00 | GRAND PIANO | 07 YAMAHA | C2 | 6162503 | 1 | Hirst, Russell D. | | 2013/02/04 00:00:00 | |
| 109808 | | RA108 | 2007/06/12 00:00:00 | 85,000.00 | GRAND PIANO | 07 STEINWAY | CONCERT | 577839 | 1 | Hirst, Russell D. | | 2013/02/04 00:00:00 | |
| 109809 | | FA201 | 2007/06/12 00:00:00 | 85,000.00 | GRAND PIANO | 07 STEINWAY | CONCERT | 578583 | 1 | Hirst, Russell D. | | 2013/02/04 00:00:00 | |
| 110059 | | FA216A | 2007/06/30 00:00:00 | 10,164.49 | PHONATORY AERODYNAMICS SYSTEM | 07 KAYPENTAX | 6600 | 27331-06 | 1 | Dewey, Cindy J. | | 2013/02/04 00:00:00 | |
| 110852 | | FA106 | 2007/09/08 00:00:00 | 5,032.00 | COMPUTER SYS (CM) | 07 APPLE | MAC PRO W/ MONITOR | G87271AUP Z | 1 | Rohrer, Thomas | | 2013/02/04 00:00:00 | |
| 110870 | | FA111 | 2007/10/01 00:00:00 | 6,695.00 | BASS CLARINET | 07 BUFFET PRESTIGE | 1193 LOW C LEFT HAND E FLAT | H42595 | | Morrison, Nicholas E. | | 2013/02/04 00:00:00 | CHECKED OUT TO STUDENT |
| 111443 | | FA105 | 2007/12/31 00:00:00 | 7,650.00 | SILVER FLUTE | 41 HAYNES | STANDARD 440 | 16497 | | Timmons, Leslie J. | | 2013/02/04 00:00:00 | |
| 116562 | | FA216A | 2008/08/27 00:00:00 | 6,589.00 | SPEECH LAB | 08 PENTAX | COMPUTERIZED CSL | 31169-12 | 1 | Dewey, Cindy J. | | 2013/02/04 00:00:00 | |
| 117961 | | FA105A | 2009/05/21 00:00:00 | 11,590.85 | COPIER | 09 SHARP | MX-M620N | | 1 | Olson, Elaine C. | | 2013/02/04 00:00:00 | |
| 118746 | | FA208 | 2002/03/01 00:00:00 | 8,000.00 | GRAND PIANO | 10 BOSTON | 156EP | 169031 | 1 | Dewey, Cindy | | 2013/02/04 00:00:00 | |
| 118949 | | FA218 | 2009/09/23 00:00:00 | 15,200.00 | GRAND PIANO | 09 BOSTON | 163 54" | 160978 | 1 | Hirst, Russell D. | | 2013/02/04 00:00:00 | |
| 118950 | | FA203B | 2006/09/15 00:00:00 | 10,000.00 | GRAND PIANO | 06 BOSTON | 178 | 150001 | 1 | Hirst, Russell D. | | 2013/02/04 00:00:00 | |
| 119691 | | AUT | 2009/08/20 00:00:00 | 15,500.00 | BOX VAN: WHITE - 9474 | 03 INTERNATIONAL | 24 FOOT | 1HTMMAAM9 3H575266 | 1 | Rohrer, Thomas | 501271EX | 2013/02/04 00:00:00 | |
| 125036 | | FA208 | 2010/08/17 00:00:00 | 11,000.00 | GRAND PIANO | 10 BOSTON | 156 EP 5' | 162735 | 1 | Hirst, Russell D. | | 2013/02/04 00:00:00 | |
| 129347 | | FA222 | 2011/04/21 00:00:00 | 64,995.00 | GRAND PIANO | 11 STEINWAY | MODEL B | 588806 | 1 | Hirst, Russell D. | | 2013/02/04 00:00:00 | |
| 129427 | | FA201 | 2011/05/04 00:00:00 | 109,895.00 | GRAND PIANO | 11 STEINWAY | MODEL D | 586963 | 1 | Hirst, Russell D. | | 2013/02/04 00:00:00 | |

MUSI \$5000 AND OVER FINANCIAL INVENTORY LIST 02/04/2013

| INV # | SUB | LOC | ACQ DATE | AMOUNT | DESCRIPTION | MAKE | MODEL | SERIAL/VIN # | A | G NAME | LICENSE | INV DATE | RESPONSIBLE AREA |
|--------|-----|--------|------------------------|-----------|-------------------|----------------------------|------------------------|------------------|---|------------------------|---------|------------------------|---------------------|
| 129493 | | FA217B | 2011/05/25 00:00:00 | 37,069.45 | GRAND PIANO | 11 STEINWAY | MODEL S | 587778 | 1 | Hirst, Russell D. | | 2013/02/04 00:00:00 | |
| 129494 | | FA205H | 2011/05/25 00:00:00 | 55,511.50 | GRAND PIANO | 11 STEINWAY | MODEL B | 582538 | 1 | Hirst, Russell D. | | 2013/02/04 00:00:00 | |
| 129495 | | FA202G | 2011/05/25 00:00:00 | 41,703.13 | GRAND PIANO | 11 STEINWAY | MODEL M | 582713 | 1 | Hirst, Russell D. | | 2013/02/04 00:00:00 | |
| 129496 | | FA203 | 2011/05/25 00:00:00 | 41,703.13 | GRAND PIANO | 11 STEINWAY | MODEL B | 588845 | 1 | Hirst, Russell D. | | 2013/02/04 00:00:00 | |
| 129810 | | FA208 | 2011/05/31 00:00:00 | 7,500.00 | VIOLIN | 56 JAN AN DE GEEST | 4/4 | JAN VANDEGEES | 7 | McFaul, Rebecca | | 2013/02/04 00:00:00 | |
| 130027 | | FA101 | 2011/06/10 00:00:00 | 58,805.00 | GRAND PIANO | 11 STEINWAY | MODEL B | 586920 | 1 | Hirst, Russell D. | | 2013/02/04 00:00:00 | |
| 130028 | | FA101 | 2011/06/10 00:00:00 | 50,100.00 | GRAND PIANO | 11 STEINWAY | MODEL A | 586922 | 1 | Hirst, Russell D. | | 2013/02/04 00:00:00 | |
| 130111 | | FA205B | 2011/07/06 00:00:00 | 40,000.00 | GRAND PIANO | 11 STEINWAY | MODEL S | 589915 | 1 | Hirst, Russell D. | | 2013/02/04 00:00:00 | |
| 130112 | | FA202E | 2011/06/30 00:00:00 | 40,000.00 | GRAND PIANO | 11 STEINWAY | MODEL S | 589781 | 1 | Hirst, Russell D. | | 2013/02/04 00:00:00 | |
| 130113 | | FA205D | 2011/05/30 00:00:00 | 40,000.00 | GRAND PIANO | 11 STEINWAY | MODEL S | 589802 | 1 | Hirst, Russell D. | | 2013/02/04 00:00:00 | |
| 130114 | | FA205E | 2011/07/06 00:00:00 | 40,000.00 | GRAND PIANO | 11 STEINWAY | MODEL S | 589842 | 1 | Hirst, Russell D. | | 2013/02/04 00:00:00 | DOOR CODE 566609 |
| 130115 | | FA202F | 2011/07/06 00:00:00 | 40,000.00 | GRAND PIANO | 11 STEINWAY | MODEL S | 589914 | 1 | Hirst, Russell D. | | 2013/02/04 00:00:00 | |
| 130116 | | FA205F | 2011/07/06 00:00:00 | 41,300.00 | GRAND PIANO | 11 STEINWAY | MODEL M | 589883 | 1 | Hirst, Russell D. | | 2013/02/04 00:00:00 | |
| 130117 | | FA202C | 2011/07/06 00:00:00 | 41,300.00 | GRAND PIANO | 11 STEINWAY | MODEL M | 589877 | 1 | Hirst, Russell D. | | 2013/02/04 00:00:00 | |
| 130118 | | FA217A | 2011/07/06 00:00:00 | 41,300.00 | GRAND PIANO | 11 STEINWAY | MODEL M | 589876 | 1 | Hirst, Russell D. | | 2013/02/04 00:00:00 | |
| 130434 | | FA104 | 2011/10/10 00:00:00 | 14,066.00 | SYMPHONIC TIMPANI | 11 YAMAHA | HH SYMPHONIC | 5 INCLUDED | 1 | Nicholson, Jason E. | | 2013/02/04 00:00:00 | |
| 135974 | | RA117 | 2012/06/30 00:00:00 | 16,000.00 | GRAND PIANO | USED STEINWAY | MODEL L EBONY GRAND | 434636 | 1 | Hirst, Russell D. | | 2013/02/04 00:00:00 | |
| 135975 | | RA111 | 2012/06/30 00:00:00 | 5,500.00 | UPRIGHT PIANO | USED STEINWAY | MODEL F (WALNUT) | 410589 | 1 | Hirst, Russell D. | | 2013/02/04 00:00:00 | |
| 136251 | | FA220A | 2012/10/24 00:00:00 | 18,535.00 | CLASSICAL ORGAN | UNKWNW JOHANNUS VIVALDI | 27 2 MANUAL | 478665112 | 1 | Thomas, Lynn W. | | 2013/02/04 00:00:00 | |

| INV # | SUB | LOCATION | ACQ DATE | AMOUNT DESCRIPTION | MAKE | MODEL | SERIAL/VIN # | TAG | NAME |
|---------|-----|----------|---------------------|---|---------------|-------------------|----------------------|----------|-----------------------------|
| 00739 | | FA205B | 1967/07/01 00:00:00 | 2,595.00 PIANO GRAND | 67 KNABE | | 175455 | 0-00739 | Amano, Gary |
| 00751 | | FA202E | 1967/07/01 00:00:00 | 2,595.00 PIANO IMPERIAL | 67 KNABE | | 175453 | 0-00751 | Amano, Gary |
| 00758 | | FA213 | 1967/07/01 00:00:00 | 3,100.00 PIANO GRAND EBONY | 67 BALDWIN | 7 | 179111 | 0-00758 | Dewey, Cindy |
| 00945 | | FA203A | 1970/03/01 00:00:00 | 3,100.00 PIANO GRAND | 70 STEINWAY | B | 272758 | 0-00945 | Amano, Gary |
| 01051 | | FA104 | 1973/10/01 00:00:00 | 1,025.00 STRING BASS | 73 ROTH | 670 | | 0-01051 | NAME NOT FOUND FOR PIDM: |
| 01062 | | EL009C | 1975/03/01 00:00:00 | 2,476.00 SYNTHESIZER | 75 ARP | 2600 | | 0-01062 | Griffin, Dennis |
| 08212 | | FA124 | 1978/03/01 00:00:00 | 1,293.00 LUTE | 78 R LUNDBERG | CUSTOM BLT | KB361531 | 5-08212 | Christiansen, Michael K. |
| 08927 | | FA218 | 1978/07/01 00:00:00 | 1,116.00 KEYNOTE VISUALIZER | 78 WURLITZER | 208 | 70408 | 5-08927 | Morrison, Nicholas E. |
| 100129 | | FA103 | 2004/04/01 00:00:00 | 2,809.00 COMPUTER: POWERBOOK | 04 APPLE | PBG4 15" | W84095KJNRZ | 4-100129 | Morrison, Nicholas E. |
| 100320 | | FA216 | 2004/05/01 00:00:00 | 3,944.00 CLAVINOVA | 04 YAMAHA | CVP208 | 601749 | 4-100320 | Hirst, Russell D. |
| 100321 | | FA216 | 2004/05/01 00:00:00 | 2,470.00 CLAVINOVA | 04 YAMAHA | CVP-202 | 603580 | 4-100321 | Hirst, Russell D. |
| 100322 | | FA216 | 2004/05/01 00:00:00 | 2,470.00 CLAVINOVA | 04 YAMAHA | CVP-202 | 603570 | 1-100322 | Hirst, Russell D. |
| 100323 | | FA216 | 2004/05/01 00:00:00 | 2,470.00 CLAVINOVA | 04 YAMAHA | CVP-202 | 603579 | 4-100323 | Hirst, Russell D. |
| 100324 | | FA216 | 2004/05/01 00:00:00 | 1,398.00 CLAVINOVA | 04 YAMAHA | CLP-120 | 647404 | 1-100324 | Hirst, Russell D. |
| 100768 | | FA214 | 1966/08/01 00:00:00 | 5,832.00 GRAND PIANO CONCERT | 66 STEINWAY | D | 395276 | 1 | Hirst, Russell D. |
| 100965A | | FA208 | 2010/02/25 00:00:00 | 1,471.00 COMPUTER | 04 DELL | GX270 | | 2 | Jessop, Craig D. |
| 101254 | | FA106 | 2004/07/31 00:00:00 | 3,027.99 COMPUTER SYS (CM) | APPLE | PMG5 | | 1-101254 | Rohrer, Thomas |
| 10182 | | OTE | 1979/04/01 00:00:00 | 3,422.00 16 FT ALUM VAN BODY WHITE | 78 WILLIAMSEN | W/17"DISPLAY | YM42604NQPM | 2-10182 | Saperston, Bruce M. |
| 102185 | | FA122 | 2004/12/02 00:00:00 | 1,399.00 COMPUTER: IBOOK | APPLE | IBOOK 14" | 64231 UV44419BRCU | 4-102185 | Emile, Mark A. |
| 102225 | | 073A | 2005/01/20 00:00:00 | 1,800.00 TROMBONE (STOLEN-GONE) | 05 YAMAHA | SER5155 (STOLEN) | 388036 | | Fallis, Todd L. |
| 102715 | | FA216 | 2005/04/28 00:00:00 | 4,450.00 PIANO W/BENCH | 05 YAMAHA | CLAVINOVA CVP-307 | UCKM01168 | 1-102715 | Hirst, Russell D. |
| 102716 | | FA104 | 2005/04/28 00:00:00 | 2,470.00 PIANO W/ BENCH | 05 YAMAHA | CLAVINOVA CVP-301 | UCKM01108 | 1-102716 | Hirst, Russell D. |
| 102717 | | FA104 | 2005/04/28 00:00:00 | 2,470.00 PIANO W/BENCH | 05 YAMAHA | CLAVINOVA CVP-301 | UCKM01119 | 1-102717 | Hirst, Russell D. |
| 102718 | | FA104 | 2005/04/28 00:00:00 | 1,698.00 PIANO W/BENCH | 05 YAMAHA | CLAVINOVA CLP-130 | 640245 | 1-102718 | Hirst, Russell D. |
| 102719 | | FA104 | 2005/04/28 00:00:00 | 1,398.00 PIANO W/BENCH | 05 YAMAHA | CLAVINOVA CLP-120 | 676568 | 1-102719 | Hirst, Russell D. |
| 103295 | | FA201 | 2005/06/30 00:00:00 | 2,324.00 COMPUTER: POWERBOOK | 05 APPLE | POWERBOOK 15" | W85242DDSQ7 | 4-103295 | Amano, Gary |
| 103820 | | FA120 | 2005/08/09 00:00:00 | 1,800.00 ALTO TROMBONE | 05 YAHAMA | YSL671T | 372544 | 1-103820 | Fallis, Todd L. |
| 103833 | | FA220B | 2005/08/12 00:00:00 | 1,459.98 COMPUTER: LATITUDE | 05 DELL | 110L | GL9X181 | 4-103833 | Hearns, Maureen C. |
| 104075 | | AOC | 2005/08/31 00:00:00 | 1,934.00 COMPUTER: IBOOK PROJECTOR PURCHASED | 05 APPLE | POWERBOOK 15" | W852606SSQ6 | 4-104075 | Amano, Gary |
| 104126 | | FA220B | 2005/09/12 00:00:00 | 1,379.97 W/PCARD | 05 INFOCUS | LP540 | NOT AVAILABLE | 1-104126 | Hearns, Maureen C. |

| | | | | | | | | |
|---------|--------|---------------------|--------------------------------|---------------|-----------------|-------------|----------|-----------------------|
| 104385 | FA114 | 2005/09/30 00:00:00 | 1,699.00 COMPUTER: IMAC | 05 APPLE | I MAC 20" | QP5351UASDZ | 4-104385 | Nicholson, Jason E. |
| 105444 | FA200 | 2006/04/13 00:00:00 | 1,881.78 COMPUTER: LATITUDE | 06 DELL | INSPIRON E1705 | JV712Q91 | 4 | Olson, Kevin R. |
| 105577 | FA200 | 2006/04/30 00:00:00 | 1,121.00 COMPUTER SYS (CM) | 06 DELL | OPTIPLEX GX 620 | 5ZL7X91 | 4 | Denham, Garret D. |
| 105578 | FA200 | 2006/04/30 00:00:00 | 1,121.00 COMPUTER SYS (CM) | 06 DELL | OPTIPLEX GX 620 | DYL7X+2 | 4 | Denham, Garret D. |
| 106020 | FA216 | 2006/05/30 00:00:00 | 4,450.00 ELECTRIC PIANO | 06 YAHAMA | CLAVINOVA CVP- | | 1 | Hirst, Russell D. |
| 106021 | FA216 | | 2,970.00 CLAVINOVA PIANO | 06YAHAMA | 307 | UCLM01058 | 1 | Hirst, Russell D. |
| 106022 | FA216 | 2006/05/30 00:00:00 | 2,970.00 CLAVINOVA PIANO | 06 YAHAMA | 053006 | UCLK01032 | 1 | Hirst, Russell D. |
| 106028 | FA1 | 2006/05/31 00:00:00 | 2,538.00 COMPUTER: MACBOOK PRO | 06 APPLE | CLAVINOVA | | 1 | Hirst, Russell D. |
| 106322 | FA111 | 2007/01/26 00:00:00 | 8,663.98 BASS CLARINET | 07 BUFFET | CVP303 | UCLK01021 | 4 | Gudmundson, Jon |
| 106589 | AOC | 2006/07/20 00:00:00 | 2,035.00 COMPUTER:LAPTOP | 06 DELL | MACBOOK PRO | W20879571 | P | Morrison, Nicholas E. |
| 106816 | FA132 | 2006/09/22 00:00:00 | 1,000.59 MELLOPHONE | 06 KING | BC R13 W/LOW C | H41867 | 4 | Hirst, Russell D. |
| 106817 | FA132 | 2006/09/22 00:00:00 | 1,000.59 MELLOPHONE | 06 KING | LATITUDE D820 | 422ZG81 | P | Rohrer, Thomas |
| 106818 | FA132 | 2006/09/22 00:00:00 | 1,000.59 MELLOPHONE | 06 KING | 1121 | 140591 | P | Rohrer, Thomas |
| 106819 | FA132 | 2006/09/22 00:00:00 | 1,000.59 MELLOPHONE | 06 KING | 1121 | 140593 | P | Rohrer, Thomas |
| 106820 | FA132 | 2006/09/22 00:00:00 | 1,000.59 MELLOPHONE | 06 KING | 1121 | 140581 | P | Rohrer, Thomas |
| 106821 | FA132 | 2006/09/22 00:00:00 | 1,000.59 MELLOPHONE | 06 KING | 1121 | 140573 | P | Rohrer, Thomas |
| 106822 | FA132 | 2006/09/22 00:00:00 | 1,000.59 MELLOPHONE | 06 KING | 1121 | 138385 | P | Rohrer, Thomas |
| 106823 | FA132 | 2006/09/22 00:00:00 | 1,000.59 MELLOPHONE | 06 KING | 1121 | 140581 | P | Rohrer, Thomas |
| 106824 | FA132 | 2006/09/22 00:00:00 | 1,000.59 MELLOPHONE | 06 KING | 1121 | 139476 | P | Rohrer, Thomas |
| 106825 | FA132 | 2006/09/22 00:00:00 | 1,000.59 MELLOPHONE | 06 KING | 1121 | 139476 | P | Rohrer, Thomas |
| 106826 | FA132 | 2006/09/22 00:00:00 | 1,159.00 EUPHONIUM | 06 KING | 1121 | 140571 | P | Rohrer, Thomas |
| 106827 | FA132 | 2006/09/22 00:00:00 | 1,159.00 EUPHONIUM | 06 KING | 1121 | 140577 | P | Rohrer, Thomas |
| 106828 | FA132 | 2006/09/22 00:00:00 | 1,159.00 EUPHONIUM | 06 KING | 625 3-VALVE | 146375 | P | Rohrer, Thomas |
| 106829 | FA132 | 2006/09/22 00:00:00 | 1,159.00 EUPHONIUM | 06 KING | 625 | 140549 | P | Rohrer, Thomas |
| 106830 | FA132 | 2006/09/22 00:00:00 | 1,159.00 EUPHONIUM | 06 KING | 625 | 148835 | P | Rohrer, Thomas |
| 106831 | FA132 | 2006/09/22 00:00:00 | 1,159.00 EUPHONIUM | 06 KING | 625 | 146381 | P | Rohrer, Thomas |
| 106832 | FA132 | 2006/09/22 00:00:00 | 1,159.00 EUPHONIUM (SQUASHED) | 06 KING | 625 | 146367 | P | Rohrer, Thomas |
| 106833 | FA132 | 2006/09/22 00:00:00 | 1,159.00 EUPHONIUM | 06 KING | 625 | 148839 | P | Rohrer, Thomas |
| 107002 | FA001 | 2006/10/09 00:00:00 | 1,353.00 MARCHING QUINTS | 06 KING | 625 | 148824 | P | Rohrer, Thomas |
| 107003 | FA104 | 2006/10/09 00:00:00 | 1,353.00 MARCHING QUINTS | 06 KING | 625 | 148848 | P | Rohrer, Thomas |
| 107004 | FA001 | 2006/10/09 00:00:00 | 1,353.00 MARCHING QUINTS | 06 YAMAHA | 68023 | 2340 | P | Rohrer, Thomas |
| 107005 | FA001 | 2006/10/09 00:00:00 | 1,099.00 MARCHING BASS DRUM | 06 YAMAHA | 68023 | 2650 | P | Rohrer, Thomas |
| 107006 | FA001 | 2006/10/09 00:00:00 | 1,037.00 MARCHING BASS DRUM | 06 YAMAHA | 68023 | 2620 | P | Rohrer, Thomas |
| 107136 | FA132 | 2006/10/24 00:00:00 | 1,159.00 EUPHONIUM | 06 YAMAHA | 8230 | 12803 | P | Rohrer, Thomas |
| 107137 | FA132 | 2006/10/24 00:00:00 | 1,159.00 EUPHONIUM | 06 YAMAHA | 8226 | 3952 | P | Rohrer, Thomas |
| 107320 | FA102 | 2006/11/01 00:00:00 | 1,526.81 COMPUTER: LATITUDE | 06 KING | BARITONE 625 | 148860 | P | Rohrer, Thomas |
| 107528A | FA105 | 2002/09/01 00:00:00 | 2,770.00 COMPUTER: POWERBOOK | 06 DELL | BARITONE 625 | 148868 | P | Rohrer, Thomas |
| 108047 | FA203A | 2006/12/07 00:00:00 | 11,000.00 GRAND PIANO | 02 APPLE | LATITUDE D820 | 9QJW1C1 | 4 | Bailey, Allyson |
| | | | | USED STIENWAY | G4 | QT22627DLPS | 4-94232 | Timmons, Leslie J. |
| | | | | | GRAND | 400660 | 1 | Hirst, Russell D. |

| | | | | | | | | |
|---------|--------|---------------------|--------------------------------|--------------------|-----------------------|----------------------------|---------|--------------------------|
| 108092 | FA206 | 2010/02/25 00:00:00 | COMPUTER | DELL | OPTIPLEX 740 | F6M6SC1 | 1 | Offesen, Bradley J. |
| 108224 | FA203 | 1999/10/01 00:00:00 | 69,000.00 GRAND PIANO | 99 STEINWAY | CONCERT | 546748 | 1 | Hirst, Russell D. |
| 108226 | FA217B | 1998/04/01 00:00:00 | 13,930.00 GRAND PIANO | 97 BOSTON | 163 | B110856 | 1 | Hirst, Russell D. |
| 108262 | FA113 | 2010/02/25 00:00:00 | COMPUTER | APPLE | IMAC | W87340ERX8A | 4 | Rohrer, Thomas |
| 108271 | FA102 | 2010/02/25 00:00:00 | COMPUTER | APPLE | MINI | | 2 | Heaps, Karlee L. |
| 108274 | FA124 | 2010/02/25 00:00:00 | COMPUTER | APPLE | MACBOOK | | 5 | Christiansen, Michael K. |
| 108281 | FA213 | 2010/02/25 00:00:00 | COMPUTER | PC UNLIMITED | CUSTOM | | 1 | Ballam, Michael L. |
| 108291 | FA103 | 2001/07/01 00:00:00 | 2,159.00 COMPUTER: IBOOK | 01 APPLE | 500 | UV124A87LCD | 4-91012 | Morrison, Nicholas E. |
| 108294A | FA103 | 1999/03/01 00:00:00 | 3,614.00 COMPUTER: PWRBOOK | 99 APPLE | G3-300 | QT8520YQF7E | 1-80772 | Morrison, Nicholas E. |
| 108616 | FA200 | 2007/01/12 00:00:00 | 7,425.00 GRAND PIANO | 07 BOSTON | ES156 | 156407 | 1 | Hirst, Russell D. |
| 10873 | FA111 | 1979/06/01 00:00:00 | 2,150.00 SAXOPHONE, BARITONE | 79 SELMER | 55A | 273841 | 1-10873 | Morrison, Nicholas E. |
| 108789 | UR021 | 2007/02/02 00:00:00 | 2,444.99 COMPUTER | 07 APPLE | MACBOOK PRO | W8646A53WOH | 4 | Francis, Anne |
| 108828 | UR202 | 2007/01/25 00:00:00 | 1,584.05 COMPUTER: LATITUDE | 07 DELL | LATITUDE D820 | 7KRPFC1 | 4 | Saperston, Bruce M. |
| 108915 | AOC | 2007/02/28 00:00:00 | 2,358.00 COMPUTER: MACBOOK | 07 APPLE | MACBOOK PRO | | 4 | McFaul, Rebecca |
| 109219 | FA122 | 2007/04/30 00:00:00 | 4,906.00 COMPUTER: MAC PRO | 07 APPLE | MAC PRO | W8646AHKWOH G871246BUP2 | 1 | Emile, Mark A. |
| 109292 | FA104B | 2007/11/28 00:00:00 | 1,224.00 GLOCKENSPIEL | USED | BLACK WOOD | | | |
| 109469 | UR001 | 2007/05/25 00:00:00 | 14,795.00 GRAND PIANO | 07 YAMAHA | BASE | NONE AVAILABLE | 1 | Griffin, Dennis |
| 10948 | FA202F | 1979/08/01 00:00:00 | 3,868.00 PIANO BABY GRAND | 79 YAMAHA | C2 | 6162503 | 1 | Hirst, Russell D. |
| 10949 | FA217A | 1979/08/01 00:00:00 | 2,465.00 PIANO UPRIGHT | 79 YAMAHA | G1J | | 1-10948 | Amano, Gary |
| 109798 | FA120 | 2007/03/30 00:00:00 | 1,415.10 COMPUTER: MACBOOK | 07 APPLE | V3HS | | 1-10949 | Amano, Gary |
| 109808 | RA108 | 2007/06/12 00:00:00 | 85,000.00 GRAND PIANO | 07 STEINWAY | MACBOOK 2.0 G | MR. FREEZE | 4 | Fallis, Todd L. |
| 109809 | FA201 | 2007/06/12 00:00:00 | 85,000.00 GRAND PIANO | 07 STEINWAY | CONCERT | 577839 | 1 | Hirst, Russell D. |
| | | | PHONATORY AERODYNAMICS | | CONCERT | 578583 | 1 | Hirst, Russell D. |
| 110059 | FA216A | 2007/06/30 00:00:00 | 10,164.49 SYSTEM | 07 KAYPENTAX | 6600 | 27331-06 | 1 | Dewey, Cindy J. |
| 110852 | FA106 | 2007/09/08 00:00:00 | 5,032.00 COMPUTER SYS (CM) | 07 APPLE | MAC PRO W/ MONITOR | G87271APUPZ | 1 | Rohrer, Thomas |
| 110870 | FA111 | 2007/10/01 00:00:00 | 6,695.00 BASS CLARINET | 07 BUFFET PRESTIGE | 1193 LOW C LEFT | | | |
| 111070 | AOC | 2007/09/22 00:00:00 | 2,885.57 COMPUTER: MACBOOK PRO | 07 APPLE | HAND E FLAT | H42595 | | Morrison, Nicholas E. |
| 111251 | FA208 | 2007/12/06 00:00:00 | 1,361.85 PROJECTOR | 07 INFOCUS | MACBOOK PRO | W87290W5XAG | 5 | Wheeler, Gregory J. |
| 111275 | AOC | 2007/11/27 00:00:00 | 1,758.32 COMPUTER: MACBOOK | 07 APPLE | DLP 3000 | 1SAVCV73200582 | 1 | Dewey, Cindy J. |
| 111443 | FA105 | 2007/12/31 00:00:00 | 7,650.00 SILVER FLUTE | 41 HAYNES | MACBOOK PRO | W874708BX91 | 1 | Evans, R C. |
| 11178 | FA132 | 1979/09/01 00:00:00 | 1,452.00 CONVERTABLE TUBA | 79 MEINL-WESTON | STANDARD 440 | | | |
| 11179 | FA132 | 1979/09/01 00:00:00 | 1,452.00 CONVERTABLE TUBA | 79 MEINL-WESTON | SCALE | 16497 | P | Timmons, Leslie J. |
| 11181 | FA132 | 1979/09/01 00:00:00 | 1,452.00 CONVERTABLE TUBA | 79 MEINL-WESTON | 10C | P13183 | 1-11178 | Rohrer, Thomas |
| 11183 | FA132 | 1979/09/01 00:00:00 | 1,452.00 CONVERTABLE TUBA | 79 MEINL-WESTON | 10C | P13143 | 1-11179 | Morrison, Nicholas E. |
| 112810 | FA104 | 2008/02/13 00:00:00 | 3,300.00 TROMBONE | 79 MEINL-WESTON | 10C | P13189 | 1-11181 | Rohrer, Thomas |
| | | | | 08 EDWARDS | 10C | P13196 | 1-11183 | Rohrer, Thomas |
| | | | | | BASS | 810 | 1 | Fallis, Todd L. |

| | | | | | | | | |
|--------|--------|---------------------|----------------------------------|------------------|-----------------|--------------------|---|-------------------------|
| 112891 | AOC | 2008/05/27 00:00:00 | 1,861.60 COMPUTER: LATITUDE | 08 DELL | LATITUDE D630 | 70045-461-584-379 | 5 | Ballam, Michael L. |
| 113150 | UR021 | 2008/04/30 00:00:00 | 1,450.00 1/10 CELLO | 82 SUZUKI | 1/10 | 0609 | 4 | Francis, Anne |
| 113153 | FA102 | 2008/04/29 00:00:00 | COMPUTER:VAIO | 08 SONY | VAIO | 13000625A | 5 | Bailey, Allyson |
| 113258 | FA104C | 2008/05/21 00:00:00 | 3,394.00 PIANO | 08 YAMAHA | T116 | 316671 | 1 | Amano, Gary |
| 113259 | FA215 | 2008/05/21 00:00:00 | 4,450.00 CLAVINOVA | 08 YAMAHA | CVP307M | UCNM01005 | 1 | Amano, Gary |
| 113260 | FA216 | 2008/05/21 00:00:00 | 4,450.00 CLAVINOVA | 08 YAMAHA | CVP-307M | NCNM01006 | 1 | Amano, Gary |
| 114845 | AOC | 2008/06/05 00:00:00 | 1,571.00 COMPUTER: LATITUDE | 08 DELL | LATITUDE D630 | CNONY1414864385732 | 5 | Jessop, Craig D. |
| 115609 | AOC | 2008/07/31 00:00:00 | 3,049.00 COMPUTER: MACBOOK | 08 APPLE | MACBOOK 17" | W88300KNYP4 | 5 | Emile, Mark A. |
| 115826 | FA101 | 2008/08/22 00:00:00 | 2,491.69 COMPUTER: IMAC | 08 APPLE | IMAC 24 | W8828016284 | 4 | Amano, Gary |
| 116040 | AOC | 2008/10/03 00:00:00 | 1,619.10 COMPUTER: MACBOOK | 08 APPLE | MACBOOK | W8832C2JYJX | 5 | Bernal, Sergio |
| 116562 | FA216A | 2008/08/27 00:00:00 | 6,589.00 SPEECH LAB | 08 PENTAX | COMPUTERIZED | | | |
| 116583 | FA201 | 2008/08/09 00:00:00 | 2,599.00 COMPUTER: MACBOOK PRO | 08 APPLE | CSL | 31169-12 | 1 | Dewey, Cindy J. |
| 116898 | FA208A | 2008/10/15 00:00:00 | 755.00 COMPUTER | 08 DELL | MACBOOK PRO | W88242AWYP3 | 4 | Amano, Gary |
| 117019 | FA208A | 2008/12/17 00:00:00 | 2,003.62 ELECTROGLOTTOGRAPH | 08 DELL | OPTIPLEX GX755 | 490FKHI | 1 | Dewey, Cindy J. |
| 117934 | FA216 | 2009/05/29 00:00:00 | 1,968.00 CLAVINOVA | 08 PENTAX | 6103 PORTABLE | 31790-05 | 1 | Dewey, Cindy J. |
| 117935 | FA216 | 2009/05/29 00:00:00 | 1,968.00 PIANO: CLAVINOVA | 09 YAHAMA | CLP-340 | UCPL01016 | 1 | Amano, Gary |
| 117936 | FA216 | 2009/05/29 00:00:00 | 3,390.00 PIANO: CLAVINOVA | 09 YAHAMA | CLP-340 | UCOP01100 | 1 | Amano, Gary |
| 117937 | FA216 | 2009/05/29 00:00:00 | 3,394.00 PIANO: CLAVONOVA | 09 YAMAHA | CVP-403 | UCPL01018 | 1 | Amano, Gary |
| 117961 | FA105A | 2009/05/21 00:00:00 | 11,590.85 COPIER | 09 YAMAHA | CVP202 | 603570 | 1 | Amano, Gary |
| 118746 | FA208 | 2002/03/01 00:00:00 | 8,000.00 GRAND PIANO | 09 SHARP | MX-M620N | | 1 | Olson, Elaine C. |
| 118949 | FA218 | 2009/09/23 00:00:00 | 15,200.00 GRAND PIANO | 10 BOSTON | 156EP | 169031 | 1 | Dewey, Cindy |
| 118950 | FA203B | 2006/09/15 00:00:00 | 10,000.00 GRAND PIANO | 09 BOSTON | 163 5'4" | 160978 | 1 | Hirst, Russell D. |
| 119571 | AOC | 2009/07/31 00:00:00 | 2,577.95 COMPUTER: MACBOOK | 06 BOSTON | 178 | 150001 | 1 | Hirst, Russell D. |
| 119691 | AOC | 2009/07/31 00:00:00 | 2,577.95 COMPUTER: MACBOOK | 09 APPLE | MACBOOK PRO 17" | W89261EF8YA | 4 | Nicholson, Jason E. |
| 119691 | AUT | 2009/08/20 00:00:00 | 15,500.00 BOX VAN: WHITE: - 9474 | 03 INTERNATIONAL | 24 FOOT | 1HTMMAAM93H575266 | 1 | Rohrer, Thomas |
| 119881 | FA103 | 2009/09/10 00:00:00 | 1,215.00 CLARINET | 09 | LYRIQUE A | 082009025 | 1 | Morrison, Nicholas E. |
| 119882 | FA103 | 2009/09/10 00:00:00 | 2,215.00 CLARINET | 09 | LYRINQUE BASSET | | | |
| 120236 | FA102 | 2009/11/06 00:00:00 | 1,319.86 COMPUTER SYS (CM) | 09 DELL | A | 082009024 | 1 | Morrison, Nicholas E. |
| 120842 | AOC | 2010/02/02 00:00:00 | 1,787.98 COMPUTER: MACBOOK | 09 DELL | OPTIPLEX 960 | YTPXG | 1 | Olson, Elaine C. |
| 120844 | AOC | 2010/02/23 00:00:00 | 1,611.99 COMPUTER: MACBOOK | 10 APPLE | MACBOOK PRO 13 | | | |
| 120852 | FA104 | 2010/02/06 00:00:00 | 2,995.00 XYLOPHONE | 10 APPLE | IN | W80044ZJ66E | 4 | Ottesen, Bradley J. |
| 121315 | FA107 | 2010/07/21 00:00:00 | 1,050.00 COMPUTER SYS (CM) | 10 APPLE | MACBOOK PRO | W80065TJ66E | 4 | Fedkenheuer, William A. |
| 124868 | FA113 | 2009/04/07 00:00:00 | 1,218.00 COMPUTER: IMAC | 10 | 3.5 OCT | 219YX350A | 1 | Nicholson, Jason E. |
| 124928 | FA102 | 2010/07/15 00:00:00 | 1,614.05 COMPUTER: IMAC | 10 DELL | OPTIPLEX 980 | HR99LM1 | 1 | Jensen, Sherie |
| 125036 | FA208 | 2010/08/17 00:00:00 | 11,000.00 GRAND PIANO | 09 APPLE | IMAC 20" | QP8391MCZE3 | 4 | Rohrer, Thomas |
| | | | | 10 APPLE | IMAC 27" | QP0270JX5PM | 4 | Heaps, Karlee L. |
| | | | | 10 BOSTON | 156 EP 5' | 162735 | 1 | Hirst, Russell D. |

| | | | | | | | | |
|--------|--------|---------------------|-----------------------------|--------------------|----------------|-----------------|---|---------------------|
| 125094 | FA101 | 2010/08/10 00:00:00 | 1,599.00 COMPUTER: IMAC | 10 APPLE | IMAC 27" | QP03005GDB6 | 4 | Olson, Kevin R. |
| 125223 | FA212 | 2010/09/22 00:00:00 | 2,204.50 COMPUTER: MACBOOK | 10 APPLE | MACBOOK/G5 | G852NHERTY | 4 | Gudmundson, Jon |
| 125320 | FA105 | 2010/09/09 00:00:00 | 2,088.00 COMPUTER: MACBOOK | 10 APPLE | MACBOOK PRO 15 | W803431WAGV | 4 | Timmons, Leslie J. |
| 128528 | FA215 | 2010/10/22 00:00:00 | 1,910.15 COMPUTER: MACBOOK | 10 APPLE | MACBOOK PRO | W803320UAGV | 4 | Buttars, Ann |
| 129347 | FA222 | 2011/04/21 00:00:00 | 64,995.00 GRAND PIANO | 11 STEINWAY | MODEL B | 588806 | 1 | Hirst, Russell D. |
| 129427 | FA201 | 2011/05/04 00:00:00 | 109,895.00 GRAND PIANO | 11 STEINWAY | MODEL D | 586963 | 1 | Hirst, Russell D. |
| 129491 | FA105 | 2011/05/25 00:00:00 | 4,345.31 UPRIGHT PIANO | 11 BOSTON | 118SE/PE | 169110 | 1 | Hirst, Russell D. |
| 129492 | FA220B | 2011/05/25 00:00:00 | 4,346.39 UPRIGHT PIANO | 11 BOSTON | 118SE/PE | 170671 | 1 | Hirst, Russell D. |
| 129493 | FA217B | 2011/05/25 00:00:00 | 37,069.45 GRAND PIANO | 11 STEINWAY | MODEL S | 587778 | 1 | Hirst, Russell D. |
| 129494 | FA205H | 2011/05/25 00:00:00 | 55,511.50 GRAND PIANO | 11 STEINWAY | MODEL B | 582538 | 1 | Hirst, Russell D. |
| 129495 | FA202G | 2011/05/25 00:00:00 | 41,703.13 GRAND PIANO | 11 STEINWAY | MODEL M | 582713 | 1 | Hirst, Russell D. |
| 129496 | FA203 | 2011/05/25 00:00:00 | 41,703.13 GRAND PIANO | 11 STEINWAY | MODEL B | 588845 | 1 | Hirst, Russell D. |
| 129810 | FA208 | 2011/05/31 00:00:00 | 7,500.00 VIOLIN | 56 JAN AN DE GEEST | 4/4 | JACOBUS JAN | | |
| 130027 | FA101 | 2011/06/10 00:00:00 | 58,805.00 GRAND PIANO | 11 STEINWAY | MODEL B | VANDEGEEST 1956 | 7 | McFaul, Rebecca |
| 130028 | FA101 | 2011/06/10 00:00:00 | 50,100.00 GRAND PIANO | 11 STEINWAY | MODEL A | 586920 | 1 | Hirst, Russell D. |
| 130111 | FA205B | 2011/07/06 00:00:00 | 40,000.00 GRAND PIANO | 11 STEINWAY | MODEL S | 586922 | 1 | Hirst, Russell D. |
| 130112 | FA202E | 2011/06/30 00:00:00 | 40,000.00 GRAND PIANO | 11 STEINWAY | MODEL S | 589915 | 1 | Hirst, Russell D. |
| 130113 | FA205D | 2011/06/30 00:00:00 | 40,000.00 GRAND PIANO | 11 STEINWAY | MODEL S | 589781 | 1 | Hirst, Russell D. |
| 130114 | FA205E | 2011/07/06 00:00:00 | 40,000.00 GRAND PIANO | 11 STEINWAY | MODEL S | 589802 | 1 | Hirst, Russell D. |
| 130115 | FA202F | 2011/07/06 00:00:00 | 40,000.00 GRAND PIANO | 11 STEINWAY | MODEL S | 589842 | 1 | Hirst, Russell D. |
| 130116 | FA205F | 2011/07/06 00:00:00 | 40,000.00 GRAND PIANO | 11 STEINWAY | MODEL S | 589914 | 1 | Hirst, Russell D. |
| 130117 | FA202C | 2011/07/06 00:00:00 | 41,300.00 GRAND PIANO | 11 STEINWAY | MODEL M | 589883 | 1 | Hirst, Russell D. |
| 130118 | FA217A | 2011/07/06 00:00:00 | 41,300.00 GRAND PIANO | 11 STEINWAY | MODEL M | 589877 | 1 | Hirst, Russell D. |
| 130434 | FA104 | 2011/10/10 00:00:00 | 14,066.00 SYMPHONIC TIMPANI | 11 STEINWAY | MODEL M | 589876 | | Hirst, Russell D. |
| 130494 | FA103 | 2011/08/30 00:00:00 | 4,690.00 PIANO | 11 YAMAHA | HH SYMPHONIC | 5 INCLUDED | 1 | Nicholson, Jason E. |
| 130495 | FA104C | 2011/08/30 00:00:00 | 4,690.00 PIANO | 11 BOSTON | 118S PE | B172424 | | Hirst, Russell D. |
| 130496 | FA106 | 2011/08/30 00:00:00 | 4,690.00 PIANO | 11 BOSTON | 118S PE | B172610 | | Hirst, Russell D. |
| 130497 | FA108A | 2011/08/30 00:00:00 | 4,690.00 PIANO | 11 BOSTON | 118S PE | B172616 | | Hirst, Russell D. |
| 130498 | FA115D | 2011/08/30 00:00:00 | 4,690.00 PIANO | 11 BOSTON | 118S PE | B172602 | | Hirst, Russell D. |
| 130499 | FA116 | 2011/08/30 00:00:00 | 4,690.00 PIANO | 11 BOSTON | 118S PE | B172613 | | Hirst, Russell D. |
| 130500 | FA118 | 2011/08/30 00:00:00 | 1,000.00 PIANO | 11 BOSTON | 118S PE | B172381 | | Hirst, Russell D. |
| 130501 | FA123 | 2011/08/30 00:00:00 | 1,000.00 PIANO | BOSTON | 156 | 166678 | | Hirst, Russell D. |
| 130502 | FA202B | 2011/08/30 00:00:00 | 4,690.00 PIANO | BOSTON | 156 | 156944 | | Hirst, Russell D. |
| 130503 | FA202D | 2011/08/30 00:00:00 | 4,690.00 PIANO | 11 BOSTON | 118S PC | B172410 | | Hirst, Russell D. |
| 130504 | FA202H | 2011/08/30 00:00:00 | 4,690.00 PIANO | 11 BOSTON | 118S PE | B172426 | | Hirst, Russell D. |
| 130505 | FA202H | 2011/08/30 00:00:00 | 4,690.00 PIANO | 11 BOSTON | 118S PE | B172428 | | Hirst, Russell D. |
| 130506 | FA204 | 2011/08/30 00:00:00 | 4,690.00 PIANO | 11 BOSTON | 118S PE | B172611 | | Hirst, Russell D. |
| 130507 | FA205A | 2011/08/30 00:00:00 | 4,690.00 PIANO | 11 BOSTON | 118S PE | B172619 | | Hirst, Russell D. |
| 130508 | FA205C | 2011/08/30 00:00:00 | 4,690.00 PIANO | 11 BOSTON | 118S PE | B172618 | | Hirst, Russell D. |
| | | | | 11 BOSTON | 118S PE | B172421 | | Hirst, Russell D. |

| | | | | | | | | |
|--------|--------|---------------------|------------------------------|-------------------------|---------------------|------------|---------|-----------------------|
| 130509 | FA205C | 2011/08/30 00:00:00 | 4,690.00 PIANO | 11 BOSTON | 118S PE | B172415 | | Hirst, Russell D. |
| 130510 | FA205G | 2011/08/30 00:00:00 | 4,690.00 PIANO | 11 BOSTON | 118S PE | B172620 | | Hirst, Russell D. |
| 130511 | FA205G | 2011/08/30 00:00:00 | 4,690.00 PIANO | 11 BOSTON | 118S PE | B172412 | | Hirst, Russell D. |
| 130512 | FA206 | 2011/08/30 00:00:00 | 4,690.00 PIANO | 11 BOSTON | 118S PE | B172422 | | Hirst, Russell D. |
| 130513 | FA210 | 2011/08/30 00:00:00 | 4,690.00 PIANO | 11 BOSTON | 118S BE | B172604 | | Hirst, Russell D. |
| 130514 | FA212 | 2011/08/30 00:00:00 | 4,690.00 PIANO | 11 BOSTON | 118S PE | B172615 | | Hirst, Russell D. |
| 130515 | FA213 | 2011/08/30 00:00:00 | 4,690.00 PIANO | 11 BOSTON | 118S PE | B172624 | | Hirst, Russell D. |
| 130516 | FA217A | 2011/08/30 00:00:00 | 4,690.00 PIANO | 11 BOSTON | 118S PE | B172608 | | Hirst, Russell D. |
| 130517 | FA217A | 2011/08/30 00:00:00 | 4,690.00 PIANO | 11 BOSTON | 118S PE | B172614 | | Hirst, Russell D. |
| 130518 | FA218 | 2011/08/30 00:00:00 | 1,000.00 PIANO | BOSTON | 163 | 160978 | | Hirst, Russell D. |
| 130519 | FA219 | 2011/08/30 00:00:00 | 4,690.00 PIANO | 11 BOSTON | 118S PE | B172425 | | Hirst, Russell D. |
| 130520 | UR118 | 2011/08/30 00:00:00 | 4,690.00 PIANO | 11 BOSTON | 118S PE | B172607 | | Hirst, Russell D. |
| 130521 | RA108A | 2011/08/30 00:00:00 | 1,000.00 PIANO | BOSTON | 156 | 163987 | | Hirst, Russell D. |
| 135974 | RA117 | 2012/06/30 00:00:00 | 16,000.00 GRAND PIANO | USED STEINWAY | MODEL L EBONY GRAND | 434636 | 1 | Hirst, Russell D. |
| 135975 | RA111 | 2012/06/30 00:00:00 | 5,500.00 UPRIGHT PIANO | USED STEINWAY | MODEL F (WALNUT) | 410589 | 1 | Hirst, Russell D. |
| 136251 | FA220A | 2012/10/24 00:00:00 | 18,535.00 CLASSICAL ORGAN | UNKNWN JOHANNUS VIVALDI | 27 2 MANUAL | 478665112 | 1 | Thomas, Lynn W. |
| 15606 | FA216 | 1981/06/01 00:00:00 | 1,035.00 KEY/NOTE VISUALIZER | 81 WURLITZER | V-500-2 | 0145622 | 5-15606 | Morrison, Nicholas E. |
| 15998 | FA132 | 1981/09/01 00:00:00 | 1,690.00 TUBA CONVERTABLE | 81 MEINL WESTON | 10C | P13233 | 1-15998 | Rohrer, Thomas |
| 15999 | FA132 | 1981/09/01 00:00:00 | 1,690.00 TUBA CONVERTABLE | 81 MEINL WESTON | 10C | P13231 | 1-15999 | Rohrer, Thomas |
| 19198 | FA111 | 1983/01/01 00:00:00 | 1,569.00 SAXOPHONE TENOR | 82 SELMER | 80 | 323227 | 5-19198 | Morrison, Nicholas E. |
| 19202 | FA227 | 1983/01/01 00:00:00 | 1,795.00 RECORDER TAPE REEL | 82 AMPEX | ATR 700-2 | | 1-19202 | Saperston, Bruce M. |
| 22635 | FA111 | 1984/06/01 00:00:00 | 1,499.00 SAXOPHONE TENOR | 84 SELMER | SUPER 80 | 346631 | 1-22635 | Morrison, Nicholas E. |
| 22899 | FA301 | 1984/06/01 00:00:00 | 2,250.00 PROJECTOR MOVIE | 84 EIKI | EX300SL | 4981 | 1-22899 | Burton, Warren W. |
| 25883 | EL009C | 1985/06/01 00:00:00 | 1,405.00 MIXER | 85 YAMAHAW | MC1204 | 1624 | 1-25883 | Griffin, Dennis |
| 26744 | EL009C | 1985/10/01 00:00:00 | 2,355.00 SYNTHESIZER | 85 YAMAHA | DX7 | 90975 | 5-26744 | Griffin, Dennis |
| 26900 | EL009C | 1985/11/01 00:00:00 | 2,390.00 SYNTHESIZER | 85 YAMAHA | DX-7 | 90975 | 5-26900 | Griffin, Dennis |
| 26901 | EL009C | 1985/11/01 00:00:00 | 1,792.00 SYNTHESIZER | 85 ROLAND | JX8P | 556073 | 5-26901 | Griffin, Dennis |
| 27222 | FA214 | 1985/12/01 00:00:00 | 2,228.00 HAND BELLS SET | | | | 1-27222 | Morrison, Nicholas E. |
| 27319 | FA102 | 1986/01/01 00:00:00 | 1,494.00 VIDEO CAMERA | 85 QUASAR | VM10 | WK52611599 | 2-27319 | Saperston, Bruce M. |
| 27456 | FA104B | 1986/02/01 00:00:00 | 1,000.00 MARIMBA ROSEWOOD | USED DEAGAN | 4OCT | | 3-27456 | Griffin, Dennis |
| 36883 | UR001 | 1989/03/01 00:00:00 | 2,995.00 PIANO GRAND SMALL | 89 BALDWIN | | 284261 | 1-36883 | Amano, Gary |
| 38151 | FA112 | 1975/09/01 00:00:00 | 1,275.00 MARIMBA GRAND | 75 MUSSER | 250 | BL1408 | 1-38151 | Griffin, Dennis |
| 38152 | FA104B | 1986/06/01 00:00:00 | 1,200.00 XYLOPHONE | 86 MUSSER | M51 | BJ5652 | 2-38152 | Morrison, Nicholas E. |
| 40310 | EL009C | 1990/05/01 00:00:00 | 1,839.00 DIGITAL KBD SAMPLER | 90 ENSONIQ | EPS SAMPLR | EPS23425 | 5-40310 | Griffin, Dennis |
| 41707 | FCC | 1983/02/01 00:00:00 | 1,000.00 TABLE CONF WOOD 12' | | | | 4-41707 | Ballam, Michael L. |
| 45197 | FA104B | 1991/08/01 00:00:00 | 3,209.00 CHIMES CHROME | 91 MUSSER | M661 | B0858 | 1-45197 | Griffin, Dennis |
| 47388 | FA125E | 1992/01/01 00:00:00 | 46,000.00 GRAND PIANO 9FT | 92 STEINWAY | D | 520127 | 1 | Hirst, Russell D. |

| | | | | | | | | |
|-------|--------|---------------------|-----------------------------------|---------------|------------|-------------|---------|-----------------------|
| 48385 | FA113 | 1992/03/01 00:00:00 | 3,986.00 OBOE | 92 F LOREE | C | J204 | 7-48385 | Morrison, Nicholas E. |
| 49098 | FA104B | 1992/05/01 00:00:00 | 2,700.00 VIBRAPHONE | 92 MUSSER | M56 | BD3130 | 2-49098 | Griffin, Dennis |
| 49685 | FA113A | 1992/06/01 00:00:00 | 3,563.00 PROJECTOR OVH PORT | 92 INFOCUS | 5000FX | 9E03052 | 1-49685 | Morrison, Nicholas E. |
| 54329 | FA114 | 1993/06/01 00:00:00 | 1,666.00 TIMPANI 26IN | 93 YAMAHA | TP6026 | 502445 | 1-54329 | Griffin, Dennis |
| 54330 | FA114 | 1993/06/01 00:00:00 | 1,667.00 TIMPANI 29IN | 93 YAMAHA | TP6029 | 503284A | 1-54330 | Griffin, Dennis |
| 62950 | FA111 | 1995/05/01 00:00:00 | 1,625.00 OBOE | 95 FOX-RENARD | 330 | 11083 | 1-62950 | Rohrer, Thomas |
| 63102 | FA216 | 1995/05/01 00:00:00 | 3,290.00 LAB COMMUNICATON SYS | 95 YAMAHA | MLC100 | 1079 | 1-63102 | Amano, Gary |
| 63103 | FA218 | 1995/05/01 00:00:00 | 1,815.00 PIANO ELECTRONIC | 95 YAMAHA | CLP1225 | 19103 | 1-63103 | Amano, Gary |
| 63104 | FA218 | 1995/05/01 00:00:00 | 1,815.00 PIANO ELECTRONIC | 95 YAMAHA | CLP1225 | 19104 | 1-63104 | Amano, Gary |
| 63105 | FA218 | 1995/05/01 00:00:00 | 1,815.00 PIANO ELECTRONIC | 95 YAMAHA | CLP122S | 19136 | 1-63105 | Amano, Gary |
| 63106 | FA218 | 1995/05/01 00:00:00 | 3,717.00 PIANO W/DISK DRIVE | 95 YAMAHA | CVP85A | 4791 | 1-63106 | Amano, Gary |
| 64207 | AOC | 1995/08/01 00:00:00 | 1,155.00 CAMRECORDER HI8 | 95 SONY | CCD-TR600 | 14840 | 1-64207 | Burton, Warren W. |
| 68256 | FA215 | 1996/05/01 00:00:00 | 3,700.00 HARPSICHORD | 96 EL KOTTICK | 17C-FRENCH | | 3-68256 | Jessop, Craig D. |
| 68293 | FA218A | 1996/05/01 00:00:00 | 4,436.00 KEYBOARD | 96 YAMAHA | CVP-87A | 7255 | 1-68293 | Amano, Gary |
| 68295 | FA218 | 1996/05/01 00:00:00 | 2,509.00 KEYBOARD | 96 YAMAHA | CLP-123 | 66027 | 1-68295 | Amano, Gary |
| 68296 | FA218 | 1996/05/01 00:00:00 | 2,509.00 KEYBOARD | 96 YAMAHA | CLP-123 | 66028 | 1-68296 | Amano, Gary |
| 69306 | FA132 | 1996/08/01 00:00:00 | 4,215.00 SOUSAPHONE SILVER | 96 YAMAHA | YSH-411SWC | 101597 | 1-69306 | Rohrer, Thomas |
| 69307 | FA132 | 1996/08/01 00:00:00 | 4,215.00 SOUSAPHONE SILVER | 96 YAMAHA | YSH-411SWC | 101594 | 1-69307 | Rohrer, Thomas |
| 69308 | FA132 | 1996/08/01 00:00:00 | 4,215.00 SOUSAPHONE SILVER | 96 YAMAHA | YSH-411SWC | 101576 | 1-69308 | Rohrer, Thomas |
| 69309 | FA132 | 1996/08/01 00:00:00 | 4,215.00 SOUSAPHONE SILVER | 96 YAMAHA | YSH-411SWC | 101580 | 1-69309 | Rohrer, Thomas |
| 69310 | FA132 | 1996/08/01 00:00:00 | 4,215.00 SOUSAPHONE SILVER | 96 YAMAHA | YSH-411SWC | 101583 | 1-69310 | Rohrer, Thomas |
| 69311 | FA132 | 1996/08/01 00:00:00 | 4,215.00 SOUSAPHONE SILVER | 96 YAMAHA | YSH-411SWC | 101589 | 1-69311 | Rohrer, Thomas |
| 69312 | FA132 | 1996/08/01 00:00:00 | 4,215.00 SOUSAPHONE SILVER | 96 YAMAHA | YSH-411SWC | 101591 | 1-69312 | Rohrer, Thomas |
| 69313 | FA132 | 1996/08/01 00:00:00 | 4,215.00 SOUSAPHONE SILVER | 96 YAMAHA | YSH-411SWC | 101595 | 1-69313 | Rohrer, Thomas |
| 72469 | FA106 | 1997/05/01 00:00:00 | 1,726.00 COMPUTER: POWERMAC | 97 APPLE | 6500/225 | XB70909Q9AY | 1-72469 | Rohrer, Thomas |
| 72677 | FA208 | 1997/06/01 00:00:00 | 2,999.00 PIANO: LIGHT OAK | 97 YAMAHA | P22 | 204632 | 5-72677 | Morrison, Nicholas E. |
| 72678 | FA218 | 1997/06/01 00:00:00 | 1,727.00 DIGITAL PIANO: CLAVINOVA | 97 YAMAHA | CLP-411 | 601189 | 5-72678 | Morrison, Nicholas E. |
| 72679 | FA218 | 1997/06/01 00:00:00 | 1,727.00 DIGITAL PIANO: CLAVINOVA | 97 YAMAHA | CLP-411 | 601179 | 5-72679 | Morrison, Nicholas E. |
| 73168 | FA104 | 1997/08/01 00:00:00 | 8,961.00 MARIMBA | 97 YAMAHA | 6000 | 0211 | 1 | Griffin, Dennis |
| 75119 | FA104 | 1998/01/01 00:00:00 | 1,825.00 TIMPANI: 32IN | 98 YAMAHA | 0321649 | 505903 | 1-75119 | Griffin, Dennis |
| 75120 | FA114 | 1998/01/01 00:00:00 | 4,499.00 MARIMBA | 98 YAMAHA | YM4600 | 1467 | 1-75120 | Griffin, Dennis |
| 75121 | FA104B | 1998/01/01 00:00:00 | 3,200.00 VIBRAPHONE | 98 MUSSER | M55 | BD3116 | 1-75121 | Griffin, Dennis |
| 75255 | FA104 | 1999/10/01 00:00:00 | 6,000.00 MARIMBA W/RESONATOR | 98 YAMAHA | YM4900 | 1060 | 1 | Nicholson, Jason E. |
| 75259 | FA104 | 1998/01/01 00:00:00 | 1,825.00 TIMPANI: 29IN | 98 YAMAHA | 6029 | 506152 | 1-75259 | Griffin, Dennis |
| 75260 | FA104 | 1998/01/01 00:00:00 | 1,825.00 TIMPANI: 26IN | 98 YAMAHA | 6026 | 506062 | 1-75260 | Morrison, Nicholas E. |
| 75261 | FA104 | 1998/01/01 00:00:00 | 1,824.00 TIMPANI: 23IN | 98 YAMAHA | 6023 | 505928 | 1-75261 | Griffin, Dennis |
| 75526 | FA216 | 1998/02/01 00:00:00 | 13,500.00 ORGAN | 98 RODGERS | 7511 | ZK50296 | 1 | Bankhead, James K. |
| 76699 | FA218 | 1998/06/01 00:00:00 | 2,074.00 CLAVINOVA | 98 YAMAHA | CLP-511 | 16927 | 1-76699 | Morrison, Nicholas E. |
| 76700 | FA218 | 1998/06/01 00:00:00 | 2,074.00 CLAVINOVA | 98 YAMAHA | CLP-511 | 021121 | 1-76700 | Morrison, Nicholas E. |
| 76701 | FA216 | 1998/06/01 00:00:00 | 3,343.00 CLAVINOVA: DELUXE | 98 YAMAHA | CVP-94 | 6002465 | 1-76701 | Morrison, Nicholas E. |

| | | | | | | | | |
|-------|--------|---------------------|------------------------------|---------------|------------|-------------|---------|--------------------------|
| 76702 | FA216 | 1998/06/01 00:00:00 | 3,849.00 CLAVINOVA: DELUXE | 98 YAMAHA | CVP-96 | 003226 | 1-76702 | Morrison, Nicholas E. |
| 81250 | FV129 | 1999/05/01 00:00:00 | 11,931.00 GRAND PIANO | 99 YAMAHA | C2 | 5614051 | 4 | Hirst, Russell D. |
| 82112 | FA113 | 1999/06/01 00:00:00 | 2,089.00 OBOE | 99 RENARD | 330 | 16027 | 1-82112 | Morrison, Nicholas E. |
| 82113 | FA113B | 1999/06/01 00:00:00 | 2,089.00 OBOE | 99 RENARD | 330 | 16181 | 1-82113 | Morrison, Nicholas E. |
| 82114 | FA113B | 1999/06/01 00:00:00 | 2,089.00 OBOE | 99 RENARD | 330 | 16173 | 1-82114 | Morrison, Nicholas E. |
| 82115 | FA111 | 1999/06/01 00:00:00 | 2,377.00 BASSOON | 99 RENARD | 41 | 28279 | 1-82115 | Morrison, Nicholas E. |
| 82116 | FA111 | 1999/06/01 00:00:00 | 2,377.00 BASSOON | 99 RENARD | 41 | 28775 | 1-82116 | Morrison, Nicholas E. |
| 82117 | FA111 | 1999/06/01 00:00:00 | 2,377.00 BASSOON | 99 RENARD | 41 | 28777 | 1-82117 | Morrison, Nicholas E. |
| 83095 | FA214A | 1999/07/01 00:00:00 | 2,249.00 COMPUTER: PWRMAC | 99 APPLE | G3-400 | XB9290F5GJ5 | 1-83095 | Evans, Cory J. |
| 85044 | FA105 | 1999/12/01 00:00:00 | 4,230.00 ALTO FLUTE | 99 YAMAHA | YFLA421 | 1565 | 1-85044 | Timmons, Leslie J. |
| 85045 | FA105 | 1999/12/01 00:00:00 | 5,785.00 BASS FLUTE | 99 ALTUS | ALTUSBF822 | B476 | 1 | Timmons, Leslie J. |
| 87033 | UR021 | 2000/06/01 00:00:00 | 2,808.00 PIANO: LT OAK | 00 YAMAHA | P22 | 241337 | 4-87033 | Morrison, Nicholas E. |
| 87034 | FA216 | 2000/06/01 00:00:00 | 2,808.00 PIANO: LT OAK | 00 YAHAMA | P22 | 237552 | 4-87034 | Saperston, Bruce M. |
| 87035 | UR202 | 2000/06/01 00:00:00 | 2,808.00 PIANO: LT OAK | 00 YAHAMA | P22 | 248212 | 4-87035 | Saperston, Bruce M. |
| 87036 | FA118 | 2000/06/01 00:00:00 | 2,808.00 PIANO: LT OAK | 00 YAHAMA | P22 | 248219 | 4-87036 | Saperston, Bruce M. |
| 87037 | UR015 | 2000/06/01 00:00:00 | 2,808.00 PIANO: LT OAK | 00 YAHAMA | P22 | 248067 | 4-87037 | Morrison, Nicholas E. |
| 87038 | FA210 | 2000/06/01 00:00:00 | 2,808.00 PIANO: LT OAK | 00 YAHAMA | P22 | 246680 | 4-87038 | Morrison, Nicholas E. |
| 87039 | AOC | 2000/06/01 00:00:00 | 2,808.00 PIANO: LT OAK | 00 YAHAMA | P22 | 248065 | 4-87039 | Jessop, Craig D. |
| 87040 | UR007 | 2000/06/01 00:00:00 | 2,808.00 PIANO: DK OAK | 00 YAHAMA | P22 | 248019 | 4-87040 | Morrison, Nicholas E. |
| 87041 | FA2 | 2000/06/01 00:00:00 | 2,808.00 PIANO: DK OAK | 00 YAHAMA | P22 | 248033 | 4-87041 | Morrison, Nicholas E. |
| 87042 | UR009 | 2000/06/01 00:00:00 | 2,808.00 PIANO | 00 YAHAMA | P22 | 248275 | 4-87042 | Morrison, Nicholas E. |
| 87839 | FA217A | 2000/06/01 00:00:00 | 2,563.00 COMPUTER | 00 APPLE | G4-450 | XB023PW8J2S | 1-87839 | Dewey, Cindy J. |
| 88281 | FA213 | 2000/07/01 00:00:00 | 1,750.00 COMPUTER SYS (CM) | 00 DELL | 667 | D6ZP20B | 1-88281 | Ballam, Michael L. |
| 88302 | FA124 | 2000/07/01 00:00:00 | 1,000.00 GUITAR | USD MARTIN | d28 | 363236 | 1-88302 | Christiansen, Michael K. |
| 88315 | FA203 | 2000/07/01 00:00:00 | 3,149.00 COMPUTER: POWERBOOK | 00 APPLE | 500 | QT028022HDS | 4-88315 | Jessop, Craig D. |
| 88641 | FA214 | 2000/08/01 00:00:00 | 12,000.00 GRAND PIANO | USED STEINWAY | O | 130703 | 1 | Hirst, Russell D. |
| 88722 | FA202I | 2000/09/01 00:00:00 | 26,000.00 BABY GRAND PIANO | 00 STEINWAY | BABY GRAND | 551826 | 1 | Hirst, Russell D. |
| 88793 | FA113 | 2000/09/01 00:00:00 | 2,904.00 COMPUTER SYS (SM) | 00 APPLE | G4 D/450 | XB03421BJNX | 1-88793 | Rohrer, Thomas |
| 88794 | FA113 | 2000/09/01 00:00:00 | 2,904.00 COMPUTER SYS (CM) | 00 APPLE | G4 D/450 | XB03421AJNX | 1-88794 | Rohrer, Thomas |
| 88795 | FA113 | 2000/09/01 00:00:00 | 2,904.00 COMPUTER SYS (CM) | 00 APPLE | G4 D/450 | XB034219JNX | 1-88795 | Rohrer, Thomas |
| 88797 | FA107 | 2000/09/01 00:00:00 | 1,197.00 PRINTER: LJET 4050 | 00 HWLT PKRD | C7829B | USQF031640 | 1-88797 | Morrison, Nicholas E. |
| 89404 | FA216 | 1996/05/01 00:00:00 | 3,248.00 KEYBOARD | 96 YAMAHA | CVP-85P | 6203 | 1-89404 | Amano, Gary |
| 89615 | FA214A | 2001/02/01 00:00:00 | 4,227.00 MUSIC LIBRARY | 01 | 4UNIT | | 1-89615 | Evans, Cory J. |
| 89857 | FA205I | 2001/04/01 00:00:00 | 30,000.00 GRAND PIANO | 01 STEINWAY | M-E GRAND | 554653 | 1 | Hirst, Russell D. |
| 90006 | FA105 | 2001/04/01 00:00:00 | 1,832.00 FLUTE | 01 HOGENHUIS | CONTRABASS | | 1-90006 | Hirst, Russell D. |
| 90413 | FA219 | 2001/06/01 00:00:00 | 2,736.00 COMPUTER SYS (CMP) | 01 APPLE | PMG4 | XB1253DBKXS | 1-90413 | Hearn, Maureen C. |
| 90962 | FA218 | 2001/07/01 00:00:00 | 3,497.00 ELEC PIANO | 01 CLAVINOVA | CLP 950 | 611294 | 1-90962 | Bernal, Sergio |
| 90963 | FA104 | 2002/06/01 00:00:00 | 3,499.00 CLAVINOVA PIANO | 02 YAHAMA | CVP 107 | 7837 | 1-90963 | Morrison, Nicholas E. |
| 91008 | FA111 | 2001/08/01 00:00:00 | 2,970.00 EUPHONIUM | 01 BESSON | BN967GS | 886151 | 1-91008 | Fallis, Todd L. |
| 91011 | FA208 | 2001/07/01 00:00:00 | 2,081.00 COMPUTER: IBOOK | 01 APPLE | 500 | UV1260V3LCD | 1-91011 | Dewey, Cindy J. |

| | | | | | | | | |
|-------|--------|---------------------|--|--------------|------------|---------------|---------|--------------------------|
| 91016 | FA203 | 2001/07/01 00:00:00 | 3,764.00 COMPUTER SYS (CM) | 01 APPLE | PM G4/733 | XA12801HKXS | 1-91016 | Hirst, Russell D. |
| 91741 | FA233E | 2001/10/01 00:00:00 | 29,500.00 GRAND PIANO | 01 STEINWAY | GRAND | 522247/437 | 1 | Hirst, Russell D. |
| 92034 | FA111 | 2001/12/01 00:00:00 | 1,200.00 CLARINET | USD | E-FLAT | T4947 | 7-92034 | Morrison, Nicholas E. |
| 92262 | FA111 | 2002/02/01 00:00:00 | 7,553.00 TUBA | 02 GETZEN | G50L | 31083 | 6 | Fallis, Todd L. |
| 92616 | FA120 | 2002/03/01 00:00:00 | 8,000.00 GRAND PIANO SATIN | 02 BOSTON | 156ES | 140088 | 1 | Fallis, Todd L. |
| 92805 | FA216 | 2001/07/01 00:00:00 | 3,497.00 ELEC PIANO | 01 CLAVINOVA | CVP-105 | 607198 | 1-92805 | Morrison, Nicholas E. |
| 92806 | FA216 | 2001/07/01 00:00:00 | 3,497.00 ELEC PIANO | 01 CLAVINOVA | CVP-105 | 607217 | 1-92806 | Saperston, Bruce M. |
| 92807 | FA216 | 2001/07/01 00:00:00 | 1,698.00 ELEC PIANO | 01 CLAVINOVA | CVP105 | 606372 | 1-92807 | Morrison, Nicholas E. |
| 93186 | FA123 | 2002/06/01 00:00:00 | 3,290.00 UPRIGHT PIANO | 02 YAHAMA | P22 | 271236 | 5-93186 | Morrison, Nicholas E. |
| 93398 | FA106 | 2002/06/01 00:00:00 | 1,499.00 COMPUTER SYS (CM) | 02 APPLE | G4 733 | XBXB2211DCM1X | 1-93398 | Rohrer, Thomas |
| 93617 | FV129 | 2002/06/01 00:00:00 | 1,547.00 COMPUTER SYS (CM) | 02 DELL | GX240 | 61LML11 | 1-93617 | Jemison-Keisker, Lynn C. |
| 93774 | FA221 | 2002/07/01 00:00:00 | 1,548.00 COMPUTER SYS (CM) | 02 DELL | GX240 | DMRYL11 | 1-93774 | Mark, Letha L. |
| 94488 | FA113 | 2002/10/01 00:00:00 | 1,565.00 PRINTER: LJET 4100TN | 02 HWLT PKRD | 4100 | | 1-94488 | Morrison, Nicholas E. |
| 95294 | FA104 | 2003/02/01 00:00:00 | 1,300.00 CELLO | USD | | NOT AVAILABLE | 7 | Morrison, Nicholas E. |
| 95552 | UR202 | 2003/03/01 00:00:00 | 12,000.00 CELLO GRAND PIANO | USED | | | 4 | Francis, Anne |
| 96433 | UR005 | 2003/06/01 00:00:00 | 11,967.00 CONSERVATORY | 03 YAMAHA | 5'8" GRAND | 5981157 | 1 | Hirst, Russell D. |
| 97877 | FA212 | 2003/08/01 00:00:00 | 1,169.00 CINEMA DISPLAY COMPUTER: PWRBK | 03 APPLE | 20" | N53140TJNAF | 4-97877 | Saperston, Bruce M. |
| 97879 | FA102 | 2003/08/01 00:00:00 | 2,398.00 W/PRINTER | 03 APPLE | PBG4 15" | QT3321BDN4M | 4-97879 | Bailey, Allyson |
| 97905 | FA217A | 2003/09/01 00:00:00 | 12,500.00 GRAND PIANO | 03 BOSTON | 156ES | 144306 | 1 | Hirst, Russell D. |
| 98319 | AOC | 2003/09/01 00:00:00 | 2,496.00 COMPUTER: POWERBOOK | 03 APPLE | PB G4 | B7339534A1RZ | 4-98319 | Evans, Cory J. |
| 98587 | FA110 | 2003/10/01 00:00:00 | 10,400.00 MARIMBA | 03 | SW 1 | 3516 | 1 | Nicholson, Jason E. |
| 98798 | FA111 | 2004/01/01 00:00:00 | 2,895.00 SOPRANO SAX | 03 SELMER | SERIES III | 652362 | 1-98798 | Gudmundson, Jon |
| 98837 | FA125A | 2003/12/01 00:00:00 | 40,800.00 GRAND PIANO | 03 STEINWAY | D-EBONY | 553750 | 1 | Hirst, Russell D. |
| 99323 | FA104 | 1997/05/01 00:00:00 | 6,160.00 GRAND PIANO: WALNUT FINISH | 57 STEINWAY | GRAND | 354217 | 5 | Hirst, Russell D. |
| 99324 | FA220 | 1976/01/01 00:00:00 | 9,274.00 GRAND PIANO EBONY | 76 STEINWAY | D | 444384 | 1 | Hirst, Russell D. |
| 99325 | FA104 | 1955/06/01 00:00:00 | 6,000.00 GRAND PIANO | 55 STEINWAY | K116 | 347831 | 5 | Hirst, Russell D. |
| 99899 | AOC | 2004/03/01 00:00:00 | 2,496.00 COMPUTER: POWERBOOK | 04 APPLE | PB G4 15" | W84096T7NRZ | 4-99899 | Hearn, Maureen C. |